



# SETH GYANIRAM BANSIDHAR PODAR COLLEGE

Accredited with 'A' Grade (3.04 CGPA) by NAAC-UGC  
Recognition of college under Section 2(f)/12(B), UGC Act, 1956  
Affiliated to *Pandit Deendayal* Upadhyaya *Shekhawati University*, Sikar



## SETH GYANIRAM BANSIDHAR PODAR COLLEGE

Podar Educational Campus, Nawalgarh -

333042 (Raj.) Website:

[www.podarcollege.com](http://www.podarcollege.com)

- **4.1 - Physical Facilities**
- 4.1.1 - The Institution has adequate infrastructure and physical facilities for teaching- learning. viz., classrooms, laboratories, computing equipment etc.

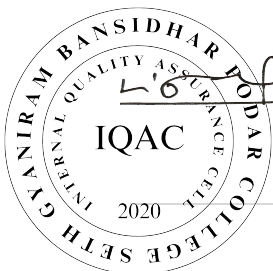



# SETH GYANIRAM BANSIDHAR PODAR COLLEGE

Accredited with 'A' Grade (3.04 CGPA) by NAAC-UGC  
Recognition of *college* under Section 2(f)/12(B), UGC Act, 1956  
Affiliated to *Pandit Deendayal* Upadhyaya *Shekhawati University*, Sikar

## 4.1.1. INDEX

### Contents

|  |    |
|--|----|
| Contents .....   | •  |
| Physical Facilities .....  | 3  |
| Classrooms/Seminar Hall with LCD / wifi/LAN facilities with room no411/413 ..... | 4  |
| College Map411 .....   | 5  |
| Main Building 1 .....  | 5  |
| Main Building 2 .....  | 6  |
| Main College Building 3 .....  | 7  |
| New Building .....   | 8  |
| Girls Hostel G.F .....   | 10 |
| GIRLS HOSTEL S.F .....   | 12 |
| Boys Hostel .....  | 13 |
| SMRITI BHAWAN .....  | 14 |
| Swimming Pool .....  | 15 |
| Sports Ground Map412 .....   | 16 |
| College View .....   | 17 |
| Main Building - Front .....  | 18 |
| APT- Corridor .....  | 28 |
| Library- Circulation Window411 .....   | 38 |
| Library-Reading Room I .....   | 41 |
| Principal Office .....   | 44 |
| Department of Chemistry411 .....   | 49 |





# SETH GYANIRAM BANSIDHAR PODAR COLLEGE

Accredited with 'A' Grade (3.04 CGPA) by NAAC-UGC  
Recognition of *college* under Section 2(f)/12(B), UGC Act, 1956  
Affiliated to *Pandit Deendayal* Upadhyaya *Shekhawati University*, Sikar

## Physical Facilities

### List of Classroom and Seminar Hall:-

| Sr. No. | Items                          | Numbers |
|---------|--------------------------------|---------|
| 1       | Class Room                     | 35      |
| 2       | Seminar Hall                   | 03      |
| 3       | Smart Rooms                    | 03      |
| 4       | Laboratories                   | 23      |
| 5       | Class Room with ICT Facilities | 12      |
| 6       | Staff Room                     | 7       |
| 7       | Store Room                     | 7       |





# SETH GYANIRAM BANSIDHAR PODAR COLLEGE

Accredited with 'A' Grade (3.04 CGPA) by NAAC-UGC  
Recognition of college under Section 2(f)/12(B), UGC Act, 1956  
Affiliated to Pandit Deendayal Upadhyaya Shekhawati University, Sikar

## Infrastructure details

### Main Building (Science and Administrative Block)

| S. No.              | Room No. | Department   | Area in sqm. |
|---------------------|----------|--|--------------|
| <b>Ground Floor</b> |          |  |              |
| 1                   | 1        | Account Office                                     | 35.3         |
| 2                   | 2        | Scholarship/Free ship Cell                         | 25.54        |
| 3                   | 3        | Strong Room  | 18.53        |
| 4                   | 4        | Alumni Association cell                            | 15.88        |
| 5                   | 5        | Exam office  | 16.32        |
| 6                   | 6        | Principal office                                   | 41.8         |
| 7                   | 7        | Girls common room                                  | 47.37        |
| 8                   | 8        | Career Counseling Cell Student Support Cell        | 47.37        |
| 9                   | 9        | A.P.J. Abdul Kalam Lab (Physics Lab-I)             | 47.37        |
| 10                  | 10       | H.J.Bhabha Lab (Physics Lab-II)                    | 47.37        |
| 11                  | 11       | S.N. Bose Lab (Physics Lab-III)                    | 41.8         |
| 12                  | 12       | C.V.Raman Lab (Dark Room)                          | 35.3         |
| 13                  | 13       | Physics Staff Office                               | 18.53        |
| 14                  | 14       | Vikram Sarabhai Lab (physics Lab-IV)               | 66.33        |
| 15                  | 15       | Store Room Physics                                 | 5.64         |
| <b>First Floor</b>  |          |  |              |
| 16                  | 16       | Dr.Hargovind Khurana Lab (Zoology Lab-I)           | 64.75        |
| 17                  | 17       | Zoology Staff Room                                 | 18.53        |
| 18                  | 18       | Aristotle Lab (Zoology Lab-II)                     | 35.3         |
| 19                  | 19       | J.B. Lamarck Lab(Zoology Lab-III)                  | 41.8         |
| 20                  | 20       | Salim Ali Museum                                   | 31.58        |
| 21                  | 21       | Charles Drawin Lab (Zoology Lab-IV)                | 65.96        |
| 22                  | 22       |  |              |
| 23                  | 23       | Dr.Ramnath A. Podar Auditorium                     | 327          |
| 24                  | 24       | Robert Brown Lab (Physiology & Biochemistry Lab)   | 65.96        |
| 25                  | 25       | M.S. Swaminathan Lab (Ecology & Environmental Lab) | 31.58        |
| 26                  | 26       | Birbal Sahni Lab (Plant Pathology Lab )            | 41.8         |
| 27                  | 27       | Jagdish Chandra Bose Lab (Molecular Biology Lab)   | 35.3         |
| 28                  | 28       | Botany Staff Office                                |              |
| 29                  | 29       | K.C.Mehta Lab (Microbiology Lab)                   | 18.53        |
| 30                  | 30       | Carolus Linnaeus Museum                            | 64.75        |
| <b>Second Floor</b> |          |  |              |
| 31                  | 31       | Male Facility Chemistry Department                 | 5.22         |
| 32                  | 32       | Class Room M.Sc.(Pre.) Chemistry                   | 66.66        |
| 33                  | 33       | Computer Lab Chemistry                             | 40.41        |
| 34                  | 34       | Chemical Preparation Room                          | 16.72        |

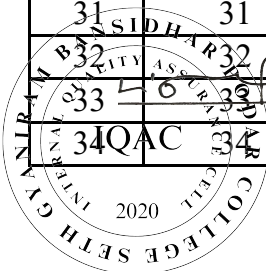



# SETH GYANIRAM BANSIDHAR PODAR COLLEGE

Accredited with 'A' Grade (3.04 CGPA) by NAAC-UGC  
 Recognition of college under Section 2(f)/12(B), UGC Act, 1956  
 Affiliated to Pandit Deendayal Upadhyaya Shekhawati University, Sikar

|   |                 |  |                     |
|---|-----------------|--|---------------------|
| 35  | 35              | Class Room M.Sc.(Final)Chemistry                   | 44.61               |
| 36  | 36              | Asima Chatterjee Lab (UG Lab Chemistry)            | 126.78              |
| 37  | 37              | Store Room Chemistry                               | 16.72               |
| 38  | 38              | Konad Lab (physical lab chemistry Pre./Final)      | 30.65               |
| 39  | 39              | Shanti Swaroop Bhatnagar Lab M.Sc.(Final)Chemistry | 31.58               |
| 40  | 40              | Chemistry Staff Office                             | 41.8                |
| 41  | 41              | Prafulla Chandra Ray Hall (Seminar Hall)           | 58.87               |
| 42  | 42              | Nagarjun Lab M.Sc.(Pre.) Chemistry Lab             | 68.6                |
| 43  | 43              | Female Facility Chemistry Department               | 5.22                |
| <b>Top Floor</b>                                    |                 |  |                     |
|   | WT              | Watch Tower  |                     |
| <b>Instructional Area</b>                           |                 |  |                     |
| <b>S. No.</b>                                       | <b>Room No.</b> | <b>Department</b>                                  | <b>Area in sqm.</b> |
| 1   | 44              | Library, Reading Room and E-Library                | 493.25              |
| <b>Mathematics Department</b>                       |                 |  |                     |
| <b>S. No.</b>                                       | <b>Room No.</b> | <b>Department</b>                                  | <b>Area in sqm.</b> |
| 1   | 45              | Class Room   | 40.3                |
| 2   | 46              | Class Room   | 38.09               |
| 3   | 47              | Mathematics Staff Office                           | 11.77               |
| 4   | 48              | Store Room Mathematics                             | 11.77               |
| 5   | 49              | Class Room   | 39.83               |
| 6   | 50              | Class Room   | 38.71               |
| <b>Medical Room</b>                                 |                 |  |                     |
| <b>S. No.</b>                                       | <b>Room No.</b> | <b>Department</b>                                  | <b>Area in sqm.</b> |
| 1   | 51              | Medical Room                                       | 9.67                |
| <b>Podar Institute of Management Studies (PIMS)</b> |                 |  |                     |
| <b>S. No.</b>                                       | <b>Room No.</b> | <b>Department</b>                                  | <b>Area in sqm.</b> |
| <b>Ground Floor</b>                                 |                 |  |                     |
| 1   | 52              | Computer Lab -I Pims                               | 70.95               |
| 2   | 53              | Computer Lab -II Pims                              | 27.17               |
| 3   | 54              | Computer Lab -III Pims                             | 27.02               |
| 4   | 55              | Store Room Pims                                    | 7                   |
| 5   | 56              | Pims Staff Office                                  | 27.17               |
| 6   | 57              | Class Room   | 27.17               |
| 7   | 58              | Smart Class-I                                      | 71.55               |
| <b>First Floor</b>                                  |                 |  |                     |
| 8   | 59              | Class Room   | 71.55               |
| 9   | 60              | Class Room   | 56.15               |
| 10  | 61              | Store Room Pims                                    | 7                   |
| 11  | 62              | Class Room   | 56.15               |
| 12  | 63              | Class Room   | 71.55               |

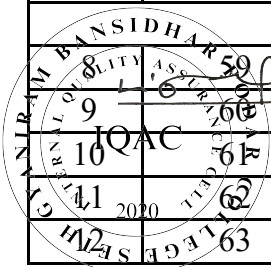



# SETH GYANIRAM BANSIDHAR PODAR COLLEGE

Accredited with 'A' Grade (3.04 CGPA) by NAAC-UGC  
Recognition of college under Section 2(f)/12(B), UGC Act, 1956  
Affiliated to Pandit Deendayal Upadhyaya Shekhawati University, Sikar

| New Building (Arts and Commerce Block) |          |   |              |
|--|----------|---|--------------|
| S. No.                                 | Room No. | Department                                      | Area in sqm. |
| <b>Ground Floor</b>                    |          |   |              |
| 1                                      | 64       | Class Room                                      | 55.5         |
| 2                                      | 65       | Class Room                                      | 67.25        |
| 3                                      | 66       | Class Room                                      | 41.8         |
| 4                                      | 67       | Class Room                                      | 29.4         |
| 5                                      | 68       | IQAC Office                                     | 30.09        |
| 6                                      | 69       | Grievance Redressal & Anti Ragging Cell         | 8.33         |
| 7                                      | 70       | Staff Room                                      | 25.5         |
| 8                                      | 71       | Department of Humanities                        | 16.72        |
| 9                                      | 72       | Department of Commerce                          | 13.37        |
| 10                                     | 73       | Geography Lab-II                                | 29.68        |
| 11                                     | 74       | Department of Geography/Geography Lab-I         | 67.25        |
| 12                                     | 75       | Class Room                                      | 55.5         |
| 13                                     | 76       | Class Room                                      | 55.5         |
| 14                                     | 77       | Class Room                                      | 67.25        |
| 15                                     | 78       | Class Room                                      | 41.8         |
| 16                                     | 79       | Class Room                                      | 60.19        |
| 17                                     | 80       | Drinking Water Facility                         | 8.36         |
| 18                                     | 81       | Class Room                                      | 42.22        |
| 19                                     | 82       | Class Room(Camera)                              | 13.37        |
| 20                                     | 83       | Class Room                                      | 29.68        |
| 21                                     | 84       | Class Room                                      | 67.25        |
| 22                                     | 85       | Class Room                                      | 55.5         |
| 23                                     | 86       | Class Room                                      | 55.5         |
| 24                                     | 87       | Class Room                                      | 67.25        |
| 25                                     | 88       | Class Room                                      | 41.8         |
| 26                                     | 89       | Class Room                                      | 60.19        |
| 27                                     | 90       | Women Empowerment & Anti Sexual Harassment Cell | 8.36         |
| 28                                     | 91       | Class Room                                      | 42.5         |
| 29                                     | 92       | Class Room                                      | 13.37        |
| 30                                     | 93       | Class Room                                      | 29.68        |
| 31                                     | 94       | Class Room                                      | 67.25        |
| 32                                     | 95       | Class Room                                      | 55.5         |
|  |          |   |              |
| S. No.                                 | Room No. | Department                                      | Area in sqm. |
|  | 96       | Girls common room                               | 19.5         |
|  | 97       | NCC office                                      | 20.43        |
|  | 98       | Scout & Guide Office                            | 9.75         |
|  | 99       | Sports Office                                   | 8.77         |
|  | 100      | NSS Office                                      | 20.26        |
|  | 103      | Canteen   | 294.45       |



# SETH GYANIRAM BANSIDHAR PODAR COLLEGE

Accredited with 'A' Grade (3.04 CGPA) by NAAC-UGC  
Recognition of college under Section 2(f)/12(B), UGC Act, 1956  
Affiliated to Pandit Deendayal Upadhyaya Shekhawati University, Sikar

| Guest House |          |                     |                |
|-------------|----------|---------------------|----------------|
| S. No.      | Room No. | Department          | Area in sqm.   |
| 1           | 101      | Principal House     | 104.82         |
| 2           | 102      | Guest House         | 104.82         |
|             |          |                     |                |
| S. No.      | Room No. | Department          | Area in sqm.   |
| 1           | 104      | Swimming Pool       | 737.25         |
| 2           | 105      | Girls Changing Room | 3.716          |
| 3           | 106      | Boy Changing Room   | 3.9            |
|             |          |                     |                |
| S. No.      | Room No. | Department          | Area in sq. m. |
| 1           | 107      | Store Room          | 14.03          |
| 2           | 108      | Store Room          | 17.96          |
| 3           | 109      | Store Room          | 8.47           |
| 4           | 110      | Store Room          | 14.12          |

| Raja Ramdeo A. Podar Sports Complex |          |                        |                |
|-------------------------------------|----------|------------------------|----------------|
| S. No.                              | Room No. | Department             | Area in sq. m. |
| 1                                   | 1        | Changing Room          | 33.44          |
| 2                                   | 2        | Office                 | 8.44           |
| 3                                   | 3        | Gymnasium              | 33.44          |
| 4                                   | 4        | Room                   | 25.08          |
| 5                                   | 5        | Green Room             | 11.7           |
| 6                                   | 6        | Green Room             | 11.7           |
| 7                                   | 7        | Toilet                 | 7.52           |
| 8                                   | 8        | Toilet Bathroom        | 3.36           |
| 9                                   | 9        | Bathroom               | 6.619          |
| 10                                  | 10       | Loby Toilet            | 4.08           |
| 11                                  | 11       | Stage                  | 37.16          |
| 12                                  | 12       | Hall for Indoor Games  | 282.41         |
| 13                                  | 13       | Bed Minton court       | 81.75          |
| 14                                  | 14       | Tenis Table            | 4.18           |
| 15                                  | 15       | Basket Ball Ground     | 409.27         |
| 16                                  | 16       | Volley Ball Ground     | 188.42         |
| 17                                  | 17       | Cricket Net            | 46.45          |
| 18                                  | 18       | Football Ground Ground |                |
| 19                                  | 19       | Under Ground Store     |                |
| 20                                  | a        | Room                   | 11.148         |
| 21                                  | b        | Room                   | 10.219         |
| 22                                  | c        | Room                   | 10.83          |

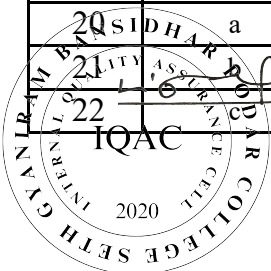



# SETH GYANIRAM BANSIDHAR PODAR COLLEGE

Accredited with 'A' Grade (3.04 CGPA) by NAAC-UGC  
Recognition of *college* under Section 2(f)/12(B), UGC Act, 1956  
Affiliated to *Pandit Deendayal* Upadhyaya *Shekhawati University*, Sikar

## Classrooms/Seminar Hall with LCD / Wi-Fi/LAN facilities with room no

| Room number or Name of classrooms/Seminar Hall with LCD / wifi/LAN facilities with room no | Type of ICT facility                                   |
|--|--|
| Master Time Table  | ICT FACILITY & LCD PROJECTOR, Smart Board              |
| PIMS   | ICT FACILITY & LCD PROJECTOR, Smart Board              |
| New Building   | ICT FACILITY & LCD PROJECTOR                           |
| Zoology Department   | ICT FACILITY & LCD PROJECTOR                           |
| Chemistry Department   | LCD PROJECTOR, Smart Board, Sound System, ICT facility |
| Physics Department   | LCD PROJECTOR, Sound System                            |
| Botany Department  | LCD PROJECTOR  |
| Seminar Hall   | ICT FACILITY & LCD PROJECTOR                           |
| Conference Hall  | LCD PROJECTOR  |
| Geography Department   | LCD PROJECTOR  |

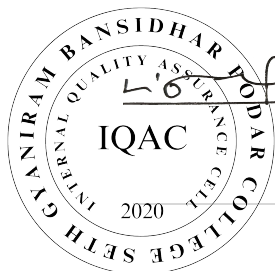





# SETH GYANIRAM BANSIDHAR PODAR COLLEGE

Accredited with 'A' Grade (3.04 CGPA) by NAAC-UGC  
Recognition of college under Section 2(f)/12(B), UGC Act, 1956  
Affiliated to Pandit Deendayal Upadhyaya Shekhawati University, Sikar

## College Map

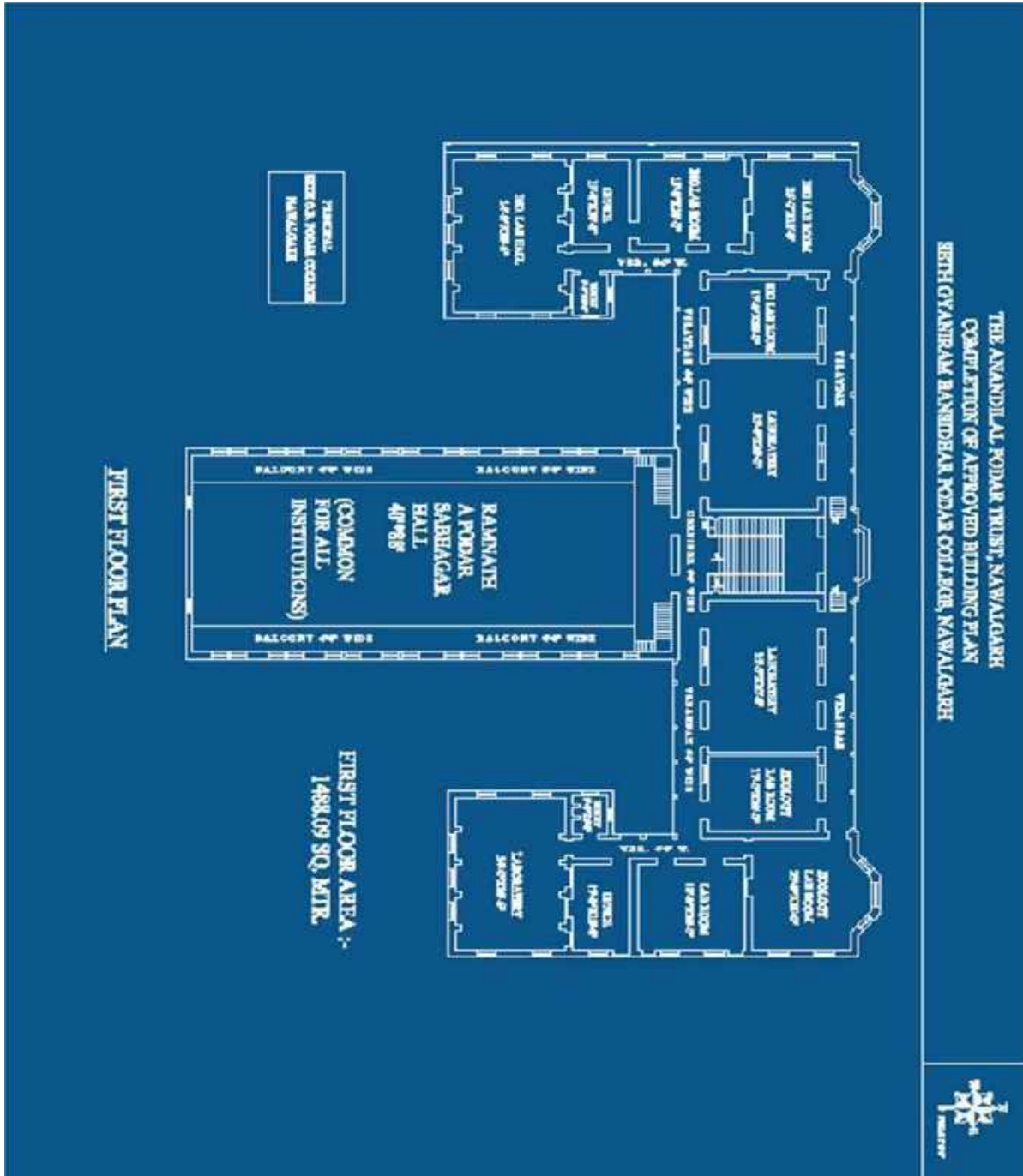

  
Main Building 1



# SETH GYANIRAM BANSIDHAR PODAR COLLEGE

Accredited with 'A' Grade (3.04 CGPA) by NAAC-UGC  
Recognition of college under Section 2(f)/12(B), UGC Act, 1956  
Affiliated to Pandit Deendayal Upadhyaya Shekhawati University, Sikar

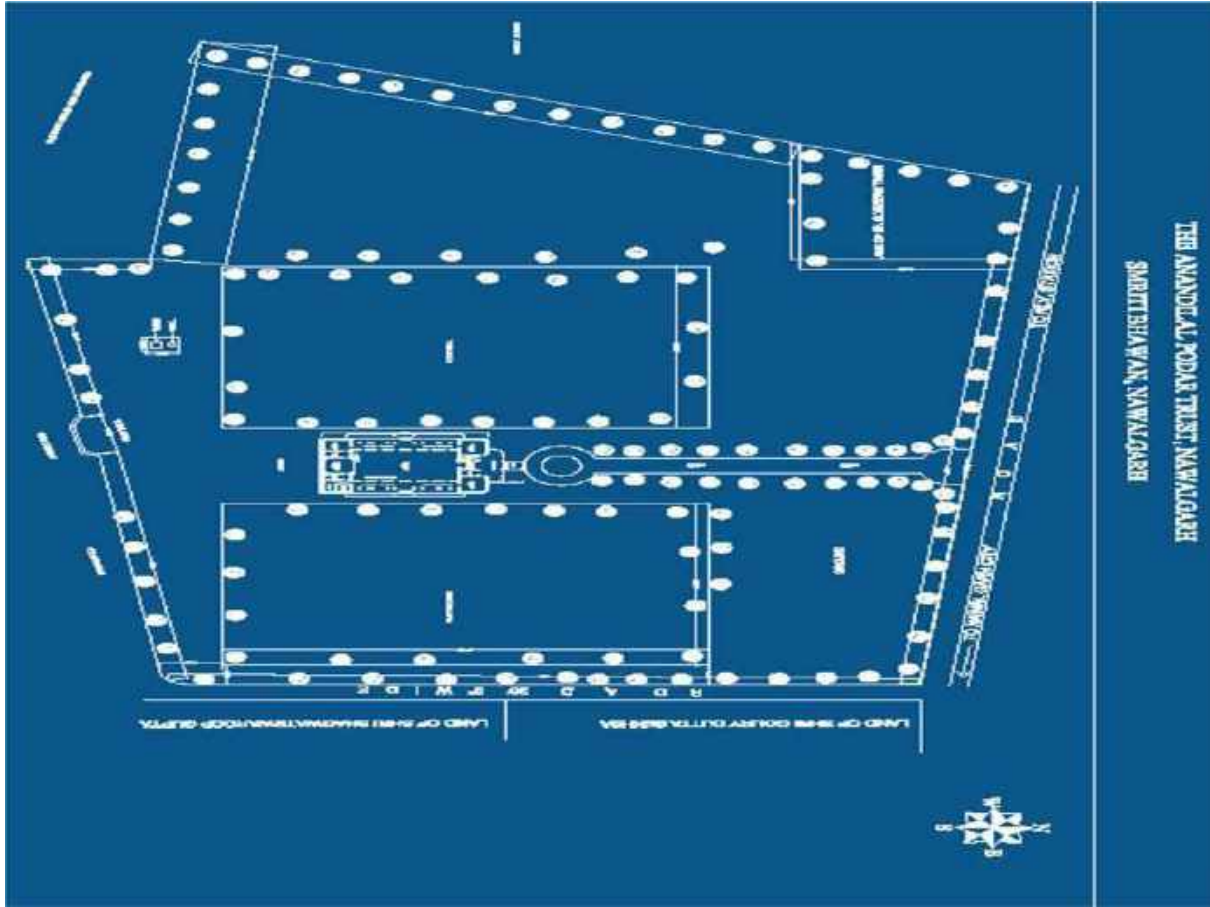

Main Building 2

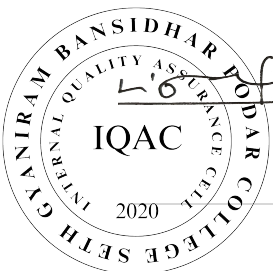



# SETH GYANIRAM BANSIDHAR PODAR COLLEGE

Accredited with 'A' Grade (3.04 CGPA) by NAAC-UGC  
Recognition of college under Section 2(f)/12(B), UGC Act, 1956  
Affiliated to Pandit Deendayal Upadhyaya Shekhawati University, Sikar

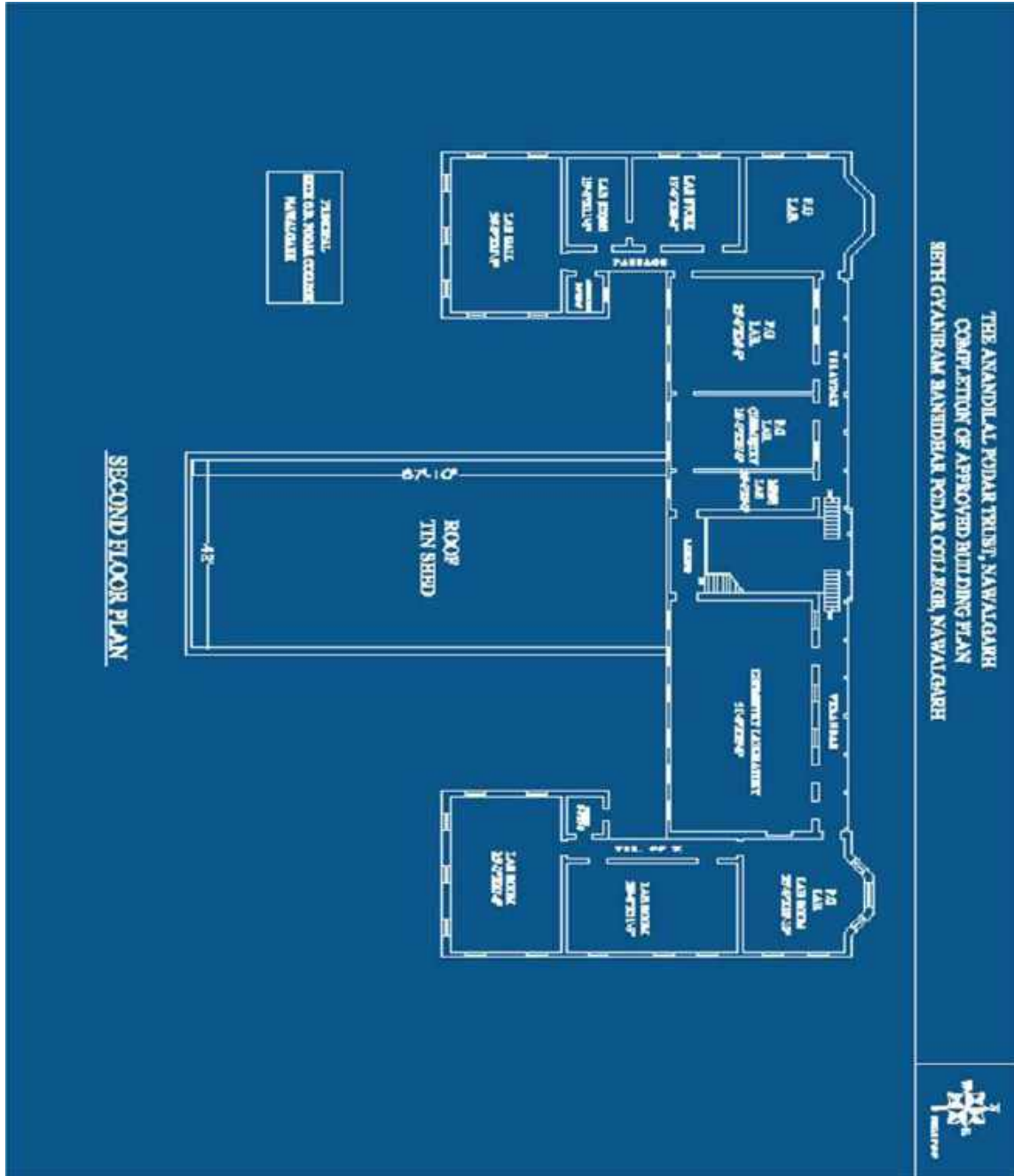

SECOND FLOOR PLAN

THE ANANDILAL PODAR TRUST, NAVALGARH  
COMPLETION OF APPROVED BUILDING PLAN  
SETH GYANIRAM BANSIDHAR PODAR COLLEGE, NAVALGARH

Main College Building 3

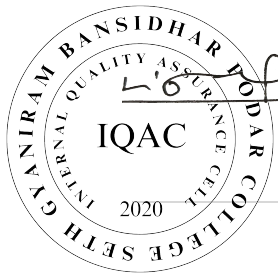



# SETH GYANIRAM BANSIDHAR PODAR COLLEGE

Accredited with 'A' Grade (3.04 CGPA) by NAAC-UGC  
Recognition of college under Section 2(f)/12(B), UGC Act, 1956  
Affiliated to Pandit Deendayal Upadhyaya Shekhawati University, Sikar

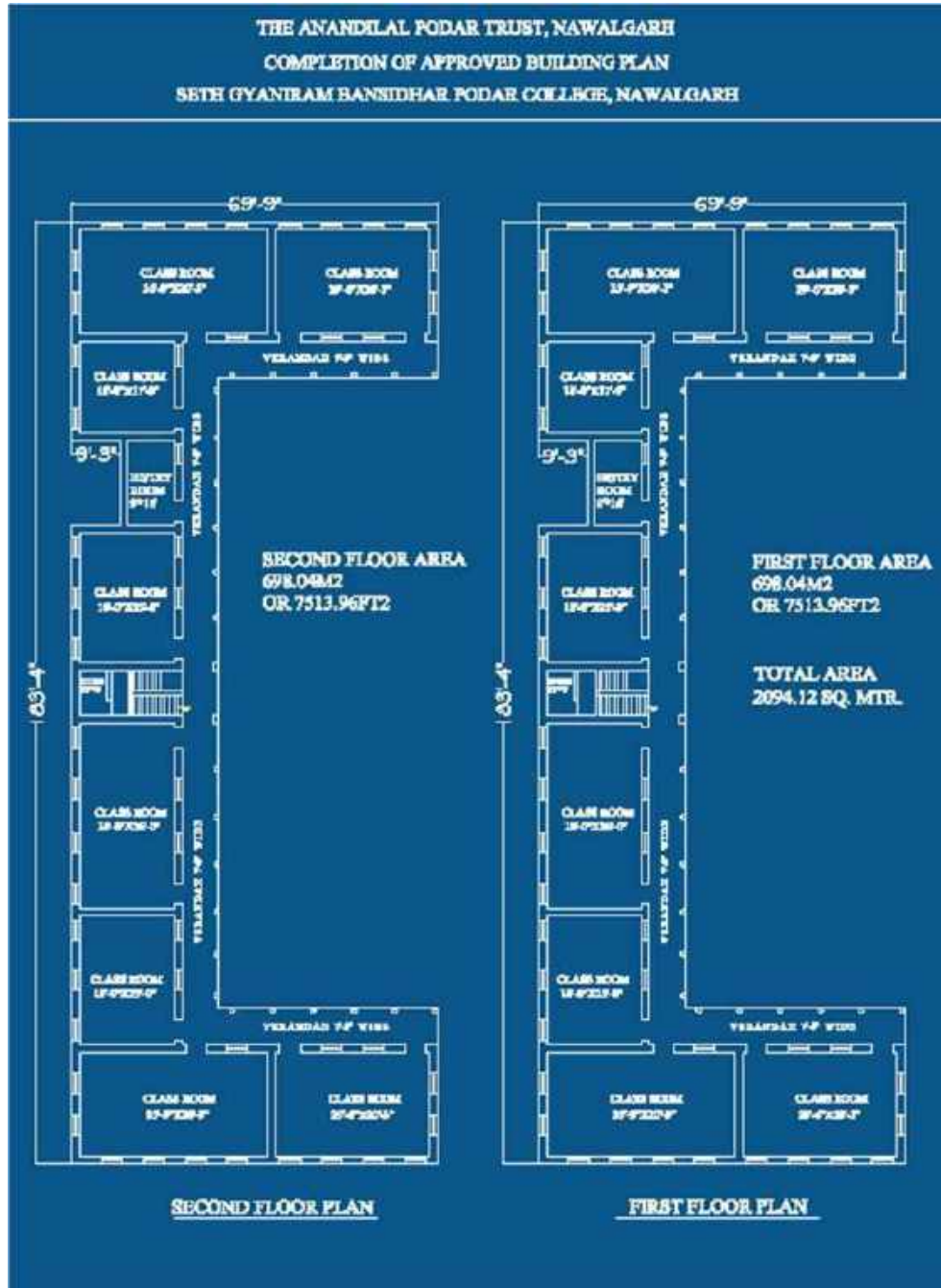

New Building







# SETH GYANIRAM BANSIDHAR PODAR COLLEGE

Accredited with 'A' Grade (3.04 CGPA) by NAAC-UGC  
Recognition of college under Section 2(f)/12(B), UGC Act, 1956  
Affiliated to Pandit Deendayal Upadhyaya Shekhawati University, Sikar

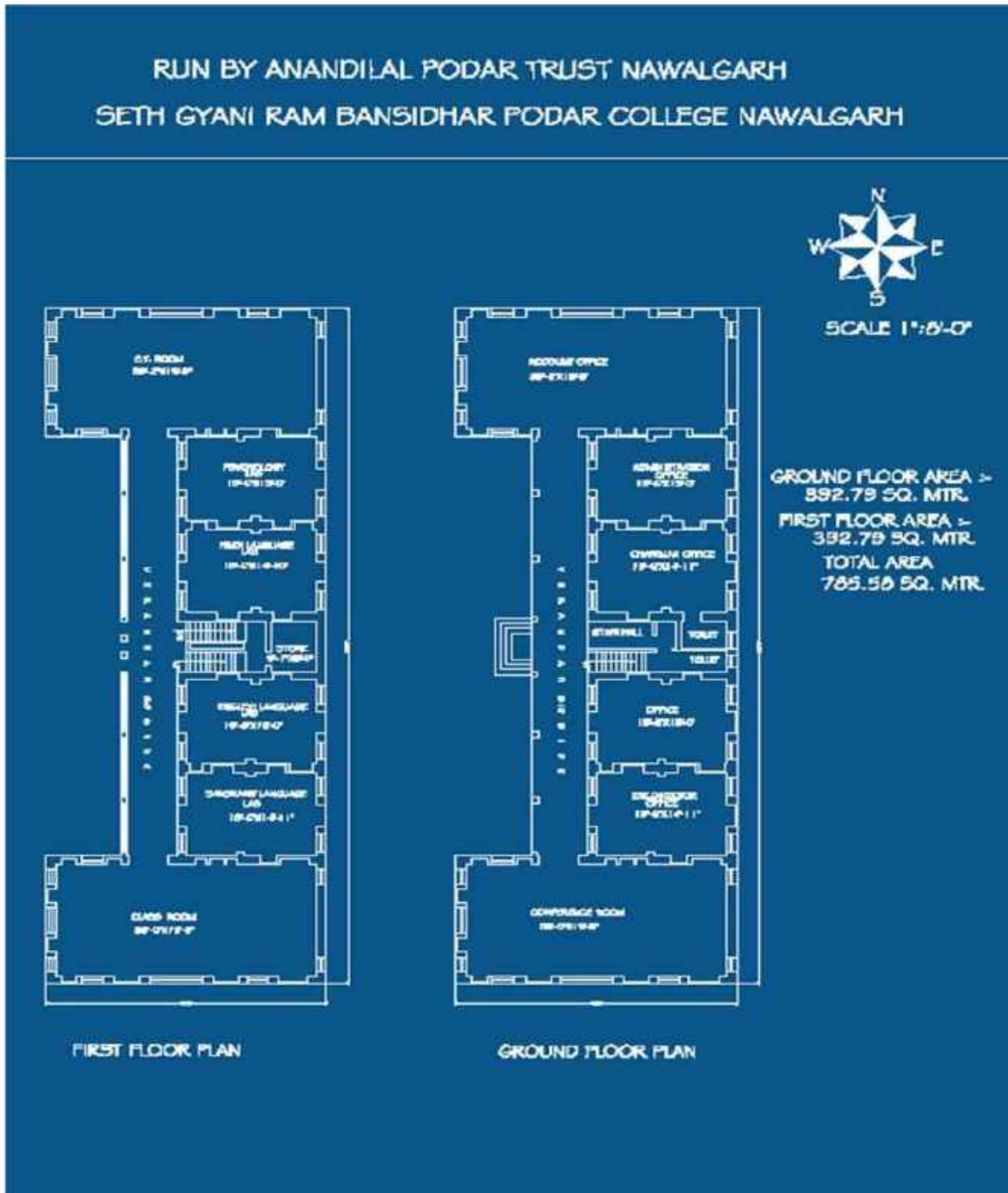

APT Building





# SETH GYANIRAM BANSIDHAR PODAR COLLEGE

Accredited with 'A' Grade (3.04 CGPA) by NAAC-UGC  
Recognition of college under Section 2(f)/12(B), UGC Act, 1956  
Affiliated to Pandit Deendayal Upadhyaya Shekhawati University, Sikar

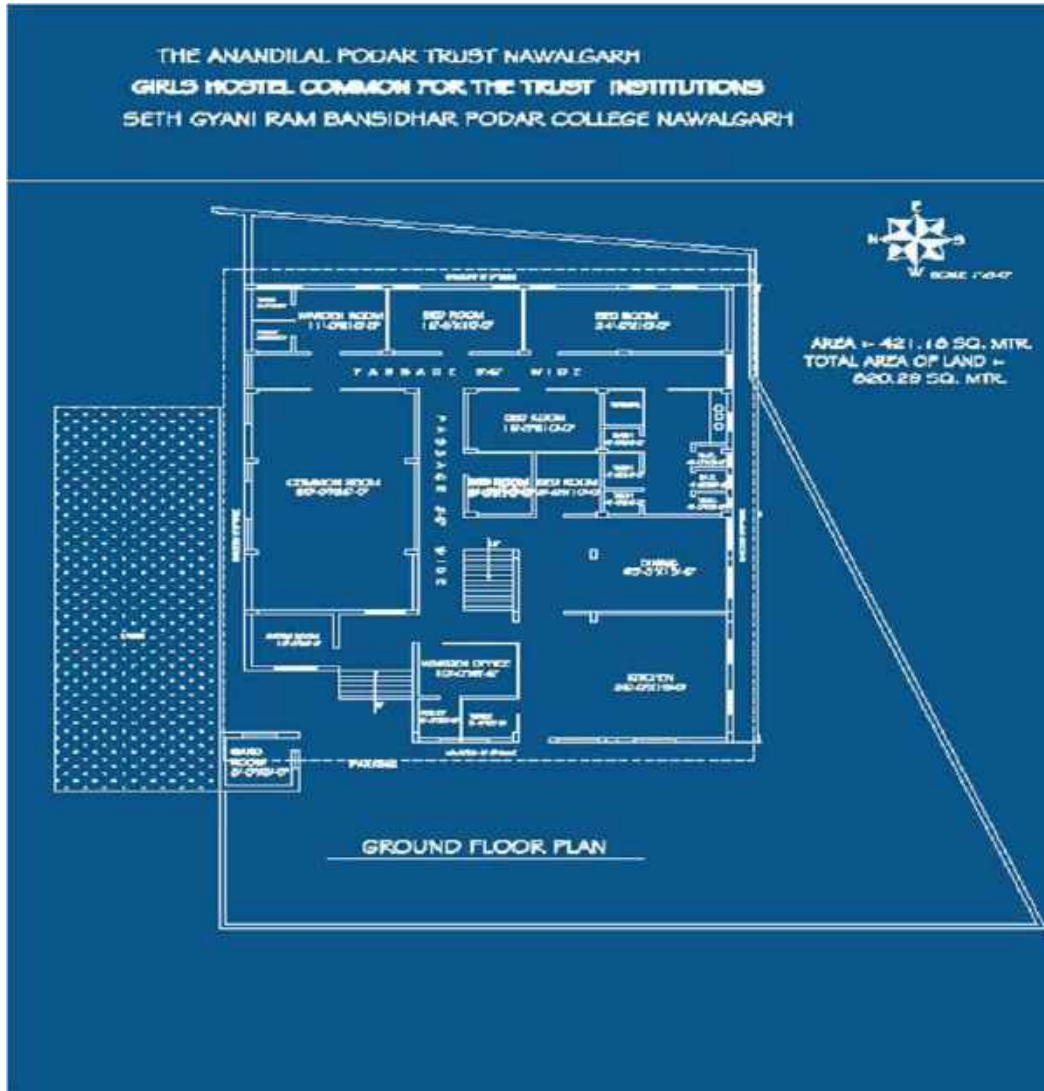

Girls Hostel Ground Floor





# SETH GYANIRAM BANSIDHAR PODAR COLLEGE

Accredited with 'A' Grade (3.04 CGPA) by NAAC-UGC  
Recognition of college under Section 2(f)/12(B), UGC Act, 1956  
Affiliated to Pandit Deendayal Upadhyaya Shekhawati University, Sikar

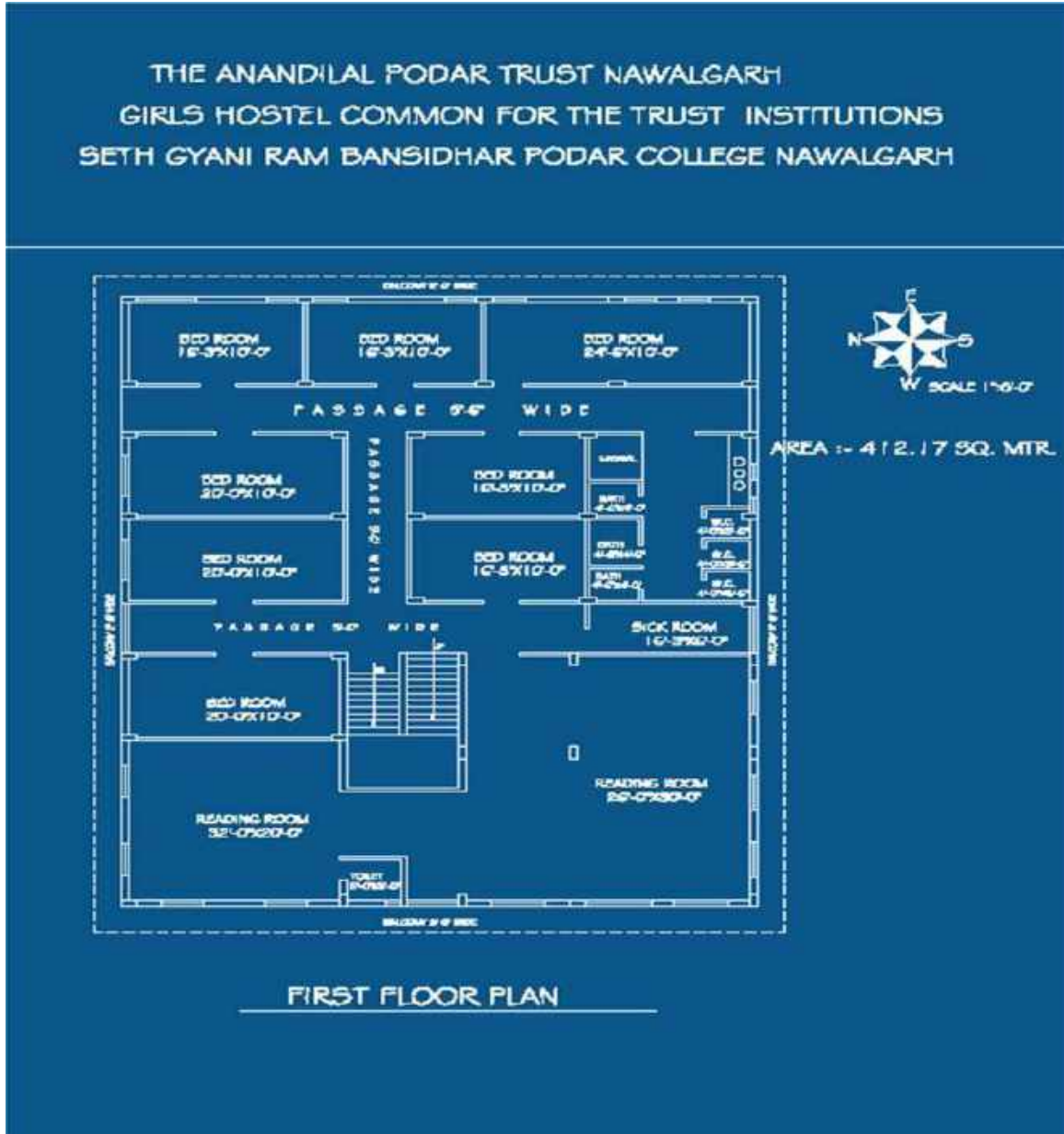

Girls Hostel First Floor



*[Handwritten signature]*



# SETH GYANIRAM BANSIDHAR PODAR COLLEGE

Accredited with 'A' Grade (3.04 CGPA) by NAAC-UGC  
Recognition of college under Section 2(f)/12(B), UGC Act, 1956  
Affiliated to Pandit Deendayal Upadhyaya Shekhawati University, Sikar

THE ANANDILAL PODAR TRUST NAWALGARH  
GIRLS HOSTEL COMMON FOR THE TRUST INSTITUTIONS  
SETH GYANI RAM BANSIDHAR PODAR COLLEGE NAWALGARH

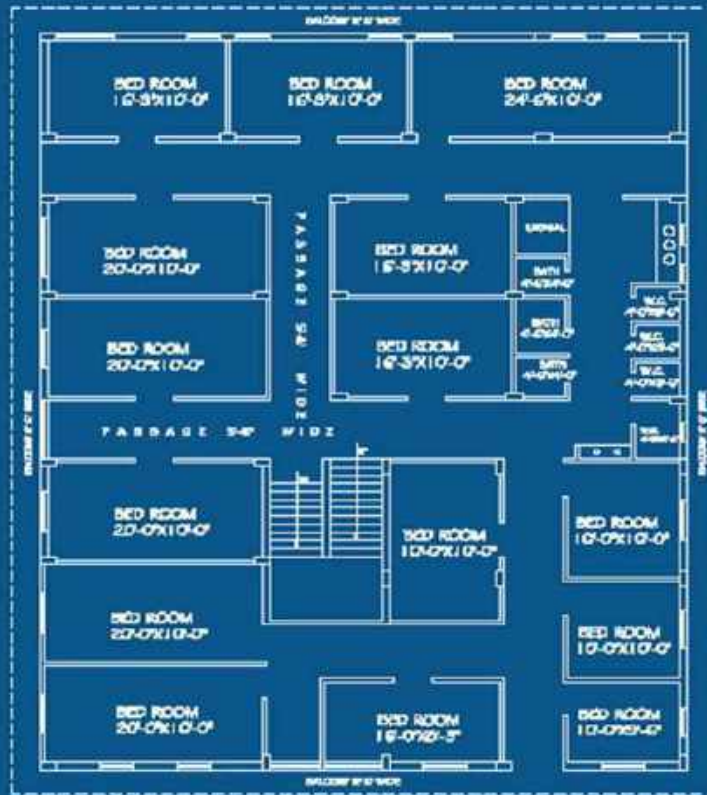

AREA :- 412.17 SQ. MTR.

SECOND FLOOR PLAN

Girls Hostel Second Floor







# SETH GYANIRAM BANSIDHAR PODAR COLLEGE

Accredited with 'A' Grade (3.04 CGPA) by NAAC-UGC  
Recognition of college under Section 2(f)/12(B), UGC Act, 1956  
Affiliated to Pandit Deendayal Upadhyaya Shekhawati University, Sikar

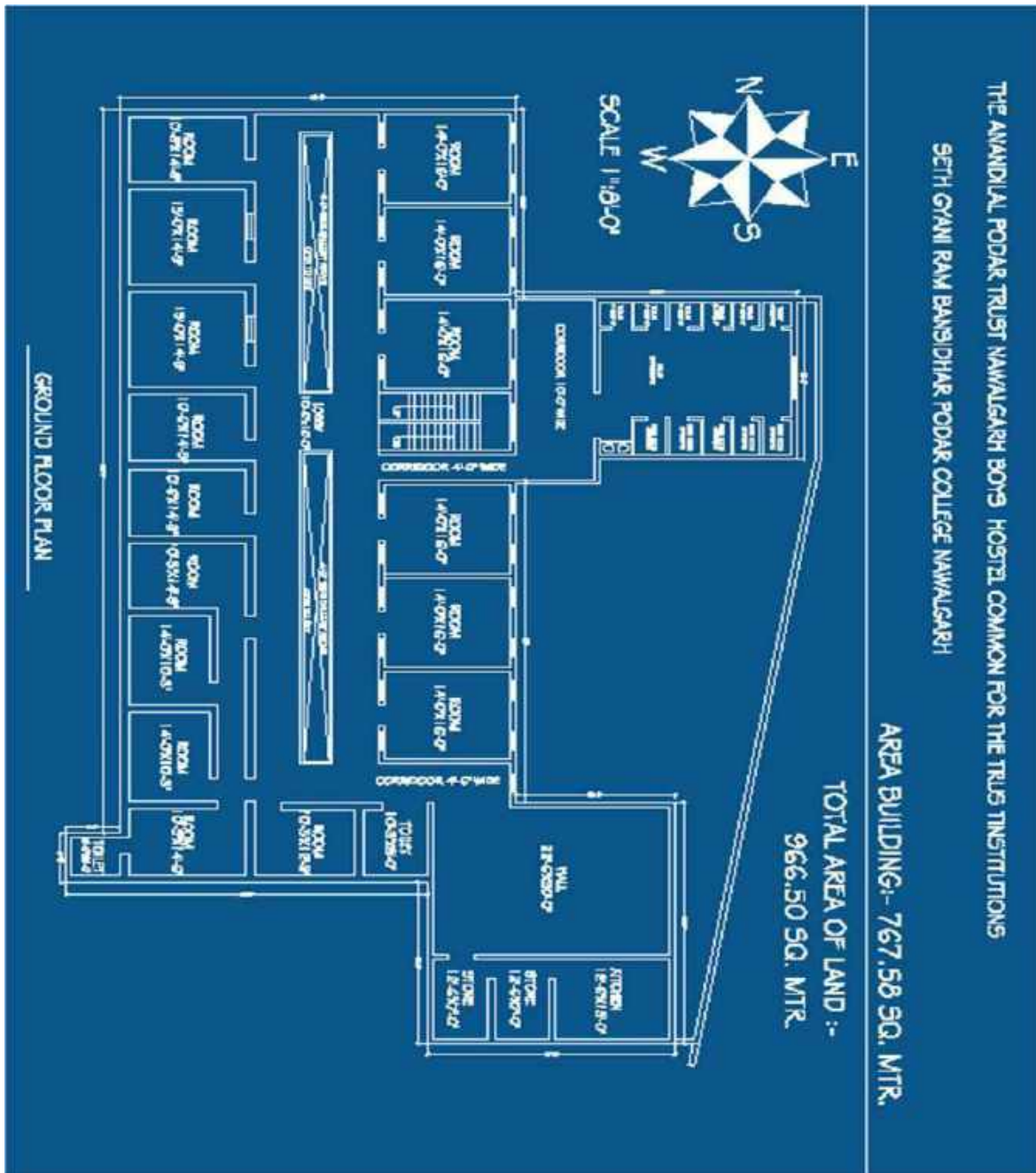

Boys Hostel





# SETH GYANIRAM BANSIDHAR PODAR COLLEGE

Accredited with 'A' Grade (3.04 CGPA) by NAAC-UGC  
Recognition of college under Section 2(f)/12(B), UGC Act, 1956  
Affiliated to Pandit Deendayal Upadhyaya Shekhawati University, Sikar

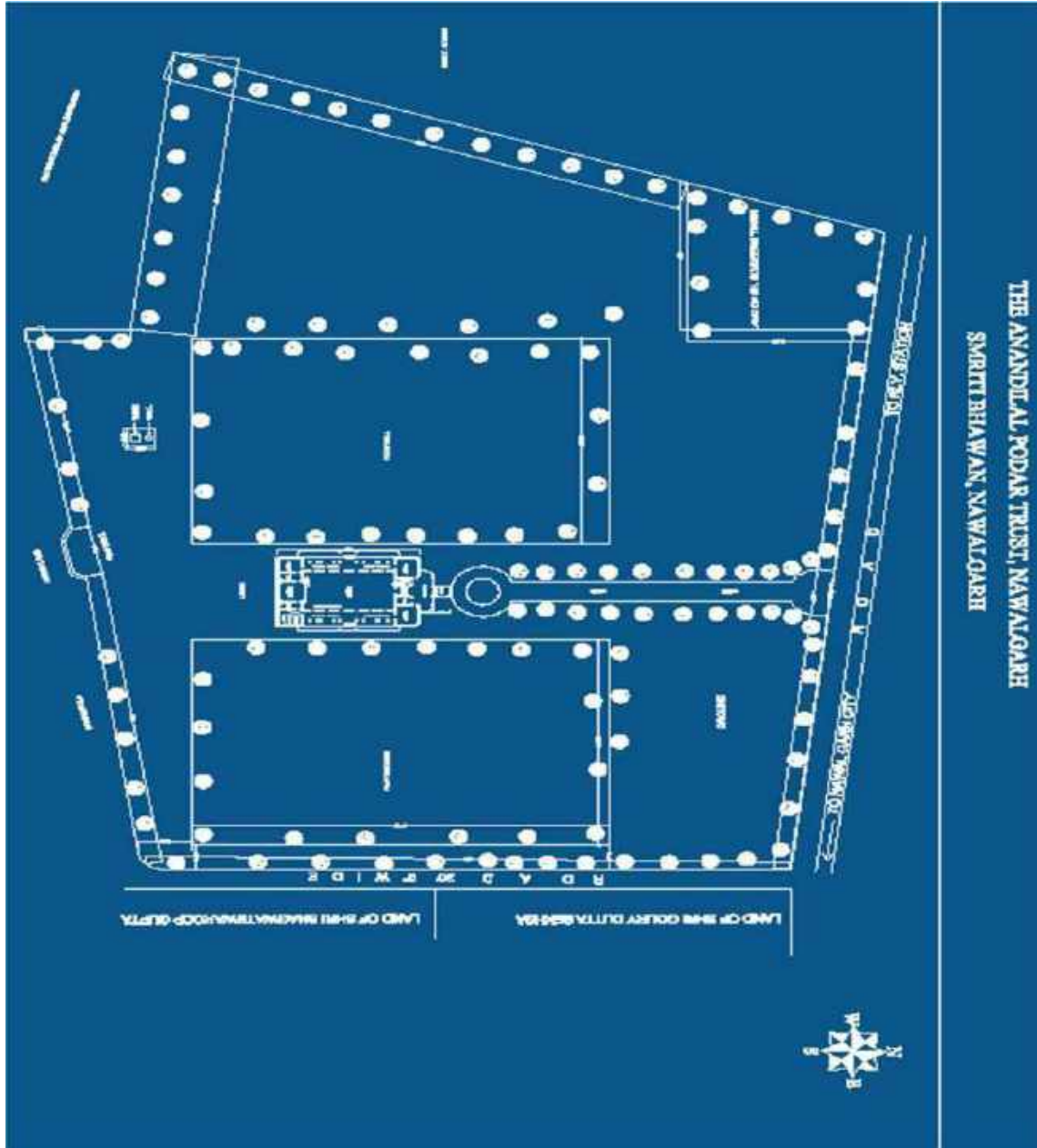

SMRITI BHAWAN

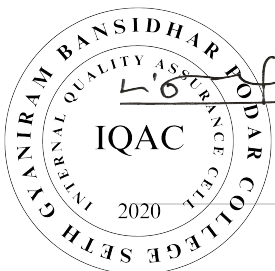



# SETH GYANIRAM BANSIDHAR PODAR COLLEGE

Accredited with 'A' Grade (3.04 CGPA) by NAAC-UGC  
Recognition of college under Section 2(f)/12(B), UGC Act, 1956  
Affiliated to Pandit Deendayal Upadhyaya Shekhawati University, Sikar

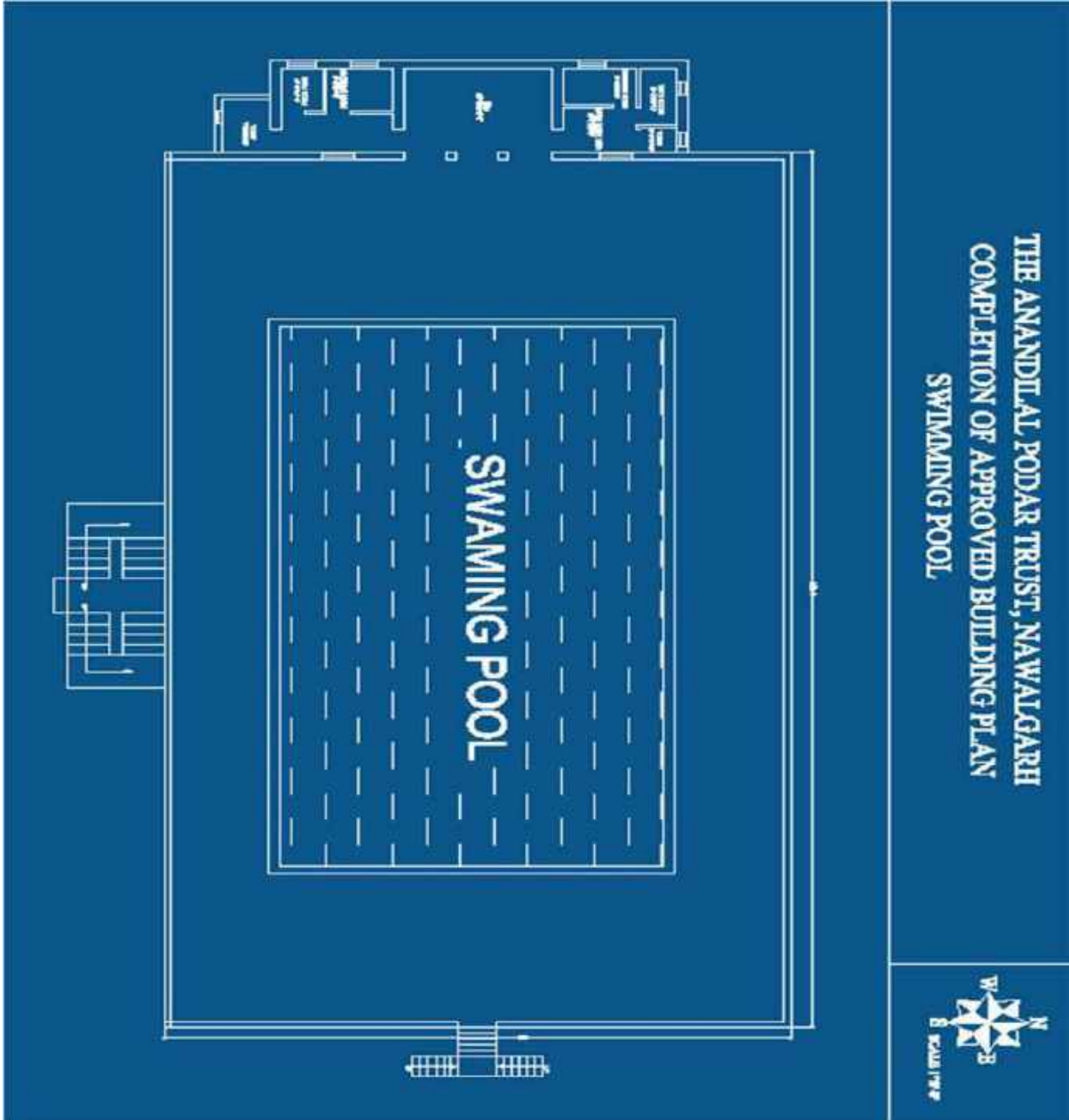

THE ANANDIAL PODAR TRUST, NAWALGARH  
COMPLETION OF APPROVED BUILDING PLAN  
SWIMMING POOL



Swimming Pool

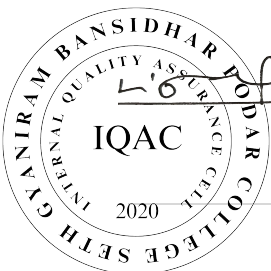



# SETH GYANIRAM BANSIDHAR PODAR COLLEGE

Accredited with 'A' Grade (3.04 CGPA) by NAAC-UGC  
Recognition of college under Section 2(f)/12(B), UGC Act, 1956  
Affiliated to Pandit Deendayal Upadhyaya Shekhawati University, Sikar



Principal  
Seth G.B. Podar College  
Nawalgarh - 333042



Sports Ground Map

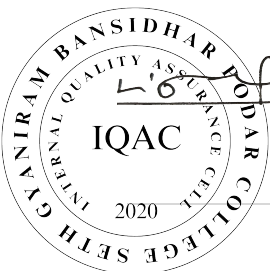

*[Handwritten signature]*





# SETH GYANIRAM BANSIDHAR PODAR COLLEGE

Accredited with 'A' Grade (3.04 CGPA) by NAAC-UGC  
Recognition of *college* under Section 2(f)/12(B), UGC Act, 1956  
Affiliated to *Pandit Deendayal* Upadhyaya *Shekhawati University*, Sikar



Front view of Science Block in Main Building of College





# SETH GYANIRAM BANSIDHAR PODAR COLLEGE

Accredited with 'A' Grade (3.04 CGPA) by NAAC-UGC  
Recognition of *college* under Section 2(f)/12(B), UGC Act, 1956  
Affiliated to *Pandit Deendayal Upadhyaya Shekhawati University*, Sikar



**Main Building- Science Block Side View**

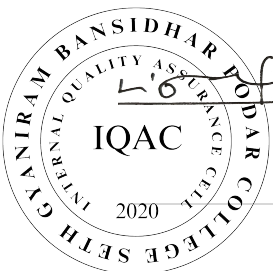

*[Handwritten Signature]*





# SETH GYANIRAM BANSIDHAR PODAR COLLEGE

Accredited with 'A' Grade (3.04 CGPA) by NAAC-UGC  
Recognition of *college* under Section 2(f)/12(B), UGC Act, 1956  
Affiliated to *Pandit Deendayal* Upadhyaya *Shekhawati University*, Sikar



## Computer Science & Management Studies





# SETH GYANIRAM BANSIDHAR PODAR COLLEGE

Accredited with 'A' Grade (3.04 CGPA) by NAAC-UGC  
Recognition of *college* under Section 2(f)/12(B), UGC Act, 1956  
Affiliated to *Pandit Deendayal* Upadhyaya *Shekhawati University*, Sikar



**New Building – Arts & Commerce Block**







# SETH GYANIRAM BANSIDHAR PODAR COLLEGE

Accredited with 'A' Grade (3.04 CGPA) by NAAC-UGC  
Recognition of *college* under Section 2(f)/12(B), UGC Act, 1956  
Affiliated to *Pandit Deendayal Upadhyaya Shekhawati University*, Sikar



Campus of College



*[Handwritten Signature]*



# SETH GYANIRAM BANSIDHAR PODAR COLLEGE

Accredited with 'A' Grade (3.04 CGPA) by NAAC-UGC  
Recognition of *college* under Section 2(f)/12(B), UGC Act, 1956  
Affiliated to *Pandit Deendayal* Upadhyaya *Shekhawati University*, Sikar



APT- Administration Block

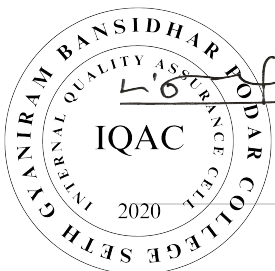





# SETH GYANIRAM BANSIDHAR PODAR COLLEGE

Accredited with 'A' Grade (3.04 CGPA) by NAAC-UGC  
Recognition of college under Section 2(f)/12(B), UGC Act, 1956  
Affiliated to Pandit Deendayal Upadhyaya Shekhawati University, Sikar



**APT- Corridor**

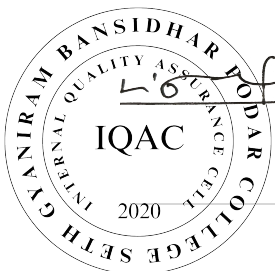



# SETH GYANIRAM BANSIDHAR PODAR COLLEGE

Accredited with 'A' Grade (3.04 CGPA) by NAAC-UGC  
Recognition of *college* under Section 2(f)/12(B), UGC Act, 1956  
Affiliated to *Pandit Deendayal* Upadhyaya *Shekhawati University*, Sikar

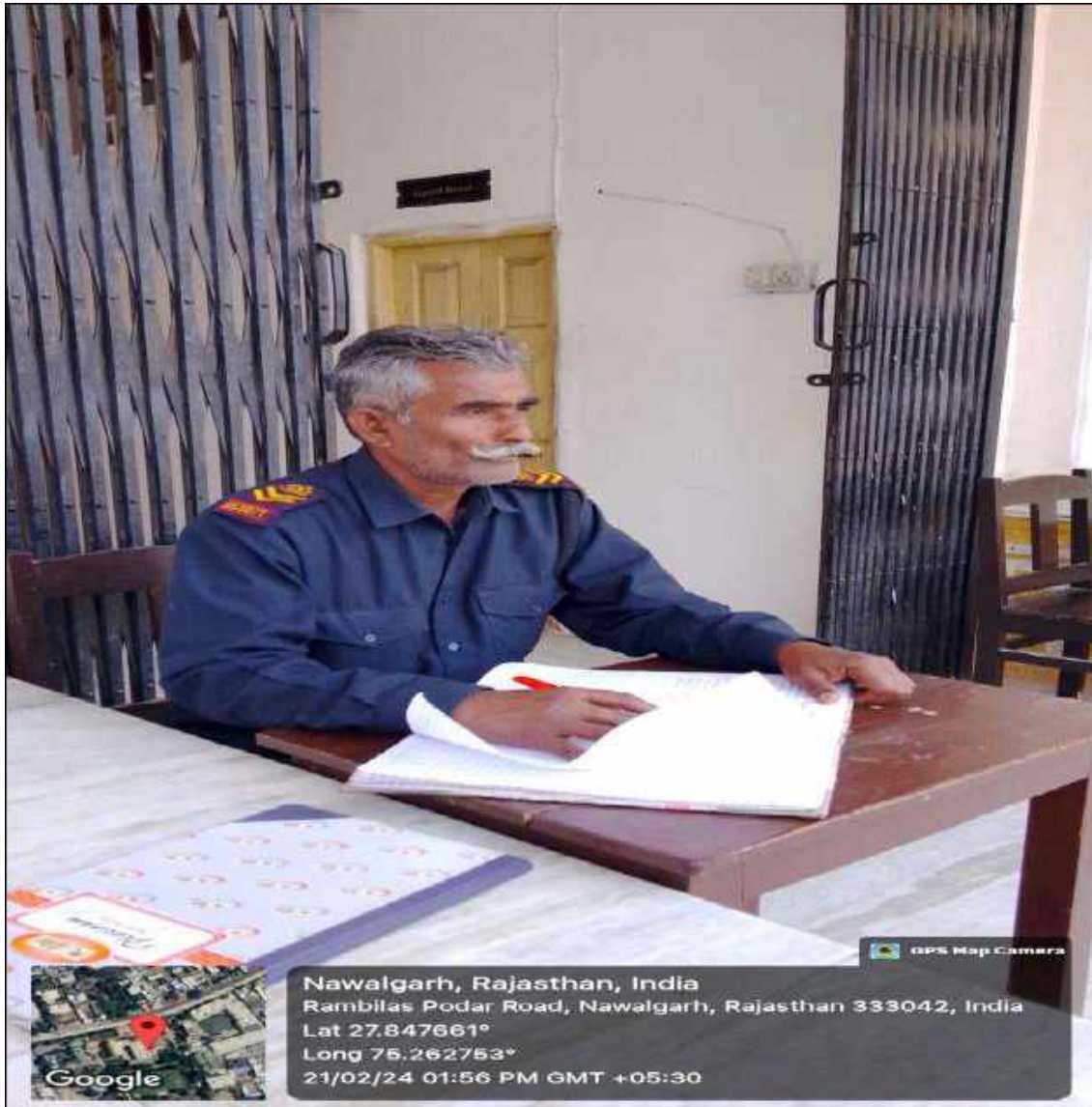

**Guard Room**





# SETH GYANIRAM BANSIDHAR PODAR COLLEGE

Accredited with 'A' Grade (3.04 CGPA) by NAAC-UGC  
Recognition of *college* under Section 2(f)/12(B), UGC Act, 1956  
Affiliated to *Pandit Deendayal* Upadhyaya *Shekhawati University*, Sikar



**Statue- Shri Madan Mohan Malviya**



**Statue- Mahatma Gandhi**



*[Handwritten signature]*





# SETH GYANIRAM BANSIDHAR PODAR COLLEGE

Accredited with 'A' Grade (3.04 CGPA) by NAAC-UGC  
Recognition of college under Section 2(f)/12(B), UGC Act, 1956  
Affiliated to Pandit Deendayal Upadhyaya Shekhawati University, Sikar



College Auditorium





# SETH GYANIRAM BANSIDHAR PODAR COLLEGE

Accredited with 'A' Grade (3.04 CGPA) by NAAC-UGC  
Recognition of *college* under Section 2(f)/12(B), UGC Act, 1956  
Affiliated to *Pandit Deendayal Upadhyaya Shekhawati University*, Sikar



 GPS Map Camera



Nawalgarh, Rajasthan, India  
V749+JVX Koolwal Marriage Garden, Nawalgarh, Rajasthan 333042, India  
Lat 27.856895°  
Long 75.27073°  
16/02/24 02:06 PM GMT +05:30

College Campus Lawn







# SETH GYANIRAM BANSIDHAR PODAR COLLEGE

Accredited with 'A' Grade (3.04 CGPA) by NAAC-UGC  
Recognition of college under Section 2(f)/12(B), UGC Act, 1956  
Affiliated to Pandit Deendayal Upadhyaya Shekhawati University, Sikar



College Library







# SETH GYANIRAM BANSIDHAR PODAR COLLEGE

Accredited with 'A' Grade (3.04 CGPA) by NAAC-UGC  
Recognition of *college* under Section 2(f)/12(B), UGC Act, 1956  
Affiliated to *Pandit Deendayal* Upadhyaya *Shekhawati University*, Sikar

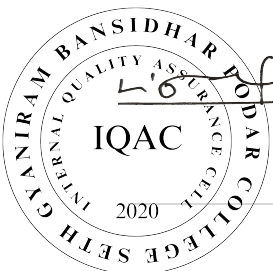



# SETH GYANIRAM BANSIDHAR PODAR COLLEGE

Accredited with 'A' Grade (3.04 CGPA) by NAAC-UGC  
Recognition of *college* under Section 2(f)/12(B), UGC Act, 1956  
Affiliated to *Pandit Deendayal* Upadhyaya *Shekhawati University*, Sikar



 **GPS Map Camera**

Nawalgarh, Rajasthan, India

V749+JVX Koolwal Marriage Garden, Nawalgarh, Rajasthan 333042, India

Lat 27.856895°

Long 75.27073°

16/02/24 01:57 PM GMT +05:30



**Library-Books**





# SETH GYANIRAM BANSIDHAR PODAR COLLEGE

Accredited with 'A' Grade (3.04 CGPA) by NAAC-UGC  
Recognition of college under Section 2(f)/12(B), UGC Act, 1956  
Affiliated to Pandit Deendayal Upadhyaya Shekhawati University, Sikar



**Principal Office**



*[Handwritten signature]*





# SETH GYANIRAM BANSIDHAR PODAR COLLEGE

Accredited with 'A' Grade (3.04 CGPA) by NAAC-UGC  
Recognition of college under Section 2(f)/12(B), UGC Act, 1956  
Affiliated to Pandit Deendayal Upadhyaya Shekhawati University, Sikar



Nawalgarh, Rajasthan, India  
V749+JVX Koolwal Marriage Garden, Nawalgarh, Rajasthan 333042, India  
Lat 27.856895°  
Long 75.27073°  
16/02/24 02:48 PM GMT +05:30

**Staff Room**





# SETH GYANIRAM BANSIDHAR PODAR COLLEGE

Accredited with 'A' Grade (3.04 CGPA) by NAAC-UGC  
Recognition of *college* under Section 2(f)/12(B), UGC Act, 1956  
Affiliated to *Pandit Deendayal* Upadhyaya *Shekhawati University*, Sikar



**Accounts Office**

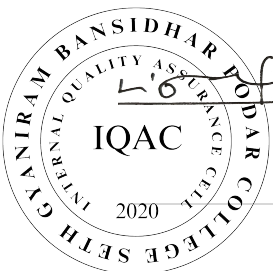



# SETH GYANIRAM BANSIDHAR PODAR COLLEGE

Accredited with 'A' Grade (3.04 CGPA) by NAAC-UGC  
Recognition of *college* under Section 2(f)/12(B), UGC Act, 1956  
Affiliated to *Pandit Deendayal Upadhyaya Shekhawati University*, Sikar

## Department of Chemistry



|            |               |
|------------|---------------|
| Department | Chemistry     |
| ICT Tool   | LCD Projector |







# SETH GYANIRAM BANSIDHAR PODAR COLLEGE

Accredited with 'A' Grade (3.04 CGPA) by NAAC-UGC  
Recognition of college under Section 2(f)/12(B), UGC Act, 1956  
Affiliated to Pandit Deendayal Upadhyaya Shekhawati University, Sikar



Department of Chemistry Laboratories & Corridor





# SETH GYANIRAM BANSIDHAR PODAR COLLEGE

Accredited with 'A' Grade (3.04 CGPA) by NAAC-UGC  
Recognition of *college* under Section 2(f)/12(B), UGC Act, 1956  
Affiliated to *Pandit Deendayal* Upadhyaya *Shekhawati University*, Sikar



|              |           |
|--------------|-----------|
| Department   | Chemistry |
| Computer Lab |           |







# SETH GYANIRAM BANSIDHAR PODAR COLLEGE

Accredited with 'A' Grade (3.04 CGPA) by NAAC-UGC  
Recognition of *college* under Section 2(f)/12(B), UGC Act, 1956  
Affiliated to *Pandit Deendayal* Upadhyaya *Shekhawati University*, Sikar



Digital P<sup>H</sup> Meter





# SETH GYANIRAM BANSIDHAR PODAR COLLEGE

Accredited with 'A' Grade (3.04 CGPA) by NAAC-UGC  
Recognition of *college* under Section 2(f)/12(B), UGC Act, 1956  
Affiliated to *Pandit Deendayal* Upadhyaya *Shekhawati University*, Sikar



Polari Meter

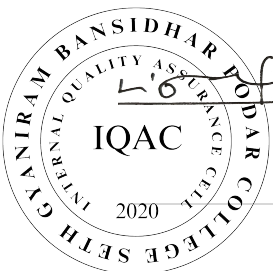



# SETH GYANIRAM BANSIDHAR PODAR COLLEGE

Accredited with 'A' Grade (3.04 CGPA) by NAAC-UGC  
Recognition of *college* under Section 2(f)/12(B), UGC Act, 1956  
Affiliated to *Pandit Deendayal* Upadhyaya *Shekhawati University*, Sikar



**Polari meter**





# SETH GYANIRAM BANSIDHAR PODAR COLLEGE

Accredited with 'A' Grade (3.04 CGPA) by NAAC-UGC  
Recognition of college under Section 2(f)/12(B), UGC Act, 1956  
Affiliated to Pandit Deendayal Upadhyaya Shekhawati University, Sikar



Electric Bunsen burner





# SETH GYANIRAM BANSIDHAR PODAR COLLEGE

Accredited with 'A' Grade (3.04 CGPA) by NAAC-UGC  
Recognition of college under Section 2(f)/12(B), UGC Act, 1956  
Affiliated to Pandit Deendayal Upadhyaya Shekhawati University, Sikar



Spectrophotometer



*[Handwritten signature]*





# SETH GYANIRAM BANSIDHAR PODAR COLLEGE

Accredited with 'A' Grade (3.04 CGPA) by NAAC-UGC  
Recognition of *college* under Section 2(f)/12(B), UGC Act, 1956  
Affiliated to *Pandit Deendayal Upadhyaya Shekhawati University*, Sikar



**Digital Melting Point Apparatus**





# SETH GYANIRAM BANSIDHAR PODAR COLLEGE

Accredited with 'A' Grade (3.04 CGPA) by NAAC-UGC  
Recognition of *college* under Section 2(f)/12(B), UGC Act, 1956  
Affiliated to *Pandit Deendayal* Upadhyaya *Shekhawati University*, Sikar



Conductivity Meter





# SETH GYANIRAM BANSIDHAR PODAR COLLEGE

Accredited with 'A' Grade (3.04 CGPA) by NAAC-UGC  
Recognition of college under Section 2(f)/12(B), UGC Act, 1956  
Affiliated to Pandit Deendayal Upadhyaya Shekhawati University, Sikar



Analytical Balance

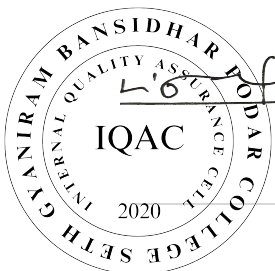

*[Handwritten signature]*



# SETH GYANIRAM BANSIDHAR PODAR COLLEGE

Accredited with 'A' Grade (3.04 CGPA) by NAAC-UGC  
Recognition of *college* under Section 2(f)/12(B), UGC Act, 1956  
Affiliated to *Pandit Deendayal* Upadhyaya *Shekhawati University*, Sikar



F-TIR

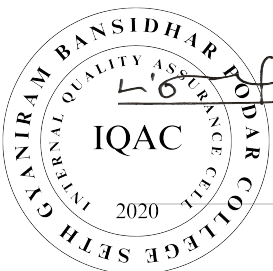





# SETH GYANIRAM BANSIDHAR PODAR COLLEGE

Accredited with 'A' Grade (3.04 CGPA) by NAAC-UGC  
Recognition of *college* under Section 2(f)/12(B), UGC Act, 1956  
Affiliated to *Pandit Deendayal Upadhyaya Shekhawati University*, Sikar



UV Spectrophotometer





# SETH GYANIRAM BANSIDHAR PODAR COLLEGE

Accredited with 'A' Grade (3.04 CGPA) by NAAC-UGC  
Recognition of *college* under Section 2(f)/12(B), UGC Act, 1956  
Affiliated to *Pandit Deendayal Upadhyaya Shekhawati University*, Sikar

## Department of Zoology



**Zoology department -Corridor**





# SETH GYANIRAM BANSIDHAR PODAR COLLEGE

Accredited with 'A' Grade (3.04 CGPA) by NAAC-UGC  
Recognition of *college* under Section 2(f)/12(B), UGC Act, 1956  
Affiliated to *Pandit Deendayal* Upadhyaya *Shekhawati University*, Sikar



|            |               |
|------------|---------------|
| Department | Zoology Lab   |
| ICT Tools  | LCD Projector |





# SETH GYANIRAM BANSIDHAR PODAR COLLEGE

Accredited with 'A' Grade (3.04 CGPA) by NAAC-UGC  
Recognition of *college* under Section 2(f)/12(B), UGC Act, 1956  
Affiliated to *Pandit Deendayal* Upadhyaya *Shekhawati University*, Sikar



Zoology Lab -1







# SETH GYANIRAM BANSIDHAR PODAR COLLEGE

Accredited with 'A' Grade (3.04 CGPA) by NAAC-UGC  
Recognition of college under Section 2(f)/12(B), UGC Act, 1956  
Affiliated to Pandit Deendayal Upadhyaya Shekhawati University, Sikar



## Zoology Lab-2





# SETH GYANIRAM BANSIDHAR PODAR COLLEGE

Accredited with 'A' Grade (3.04 CGPA) by NAAC-UGC  
Recognition of *college* under Section 2(f)/12(B), UGC Act, 1956  
Affiliated to *Pandit Deendayal Upadhyaya Shekhawati University*, Sikar



Zoology Lab - Centrifuge





# SETH GYANIRAM BANSIDHAR PODAR COLLEGE

Accredited with 'A' Grade (3.04 CGPA) by NAAC-UGC  
Recognition of *college* under Section 2(f)/12(B), UGC Act, 1956  
Affiliated to *Pandit Deendayal Upadhyaya Shekhawati University*, Sikar



**Zoology Lab - Florescent Microscope**







# SETH GYANIRAM BANSIDHAR PODAR COLLEGE

Accredited with 'A' Grade (3.04 CGPA) by NAAC-UGC  
Recognition of college under Section 2(f)/12(B), UGC Act, 1956  
Affiliated to Pandit Deendayal Upadhyaya Shekhawati University, Sikar



Zoology Lab - Model



*[Handwritten signature]*



# SETH GYANIRAM BANSIDHAR PODAR COLLEGE

Accredited with 'A' Grade (3.04 CGPA) by NAAC-UGC  
Recognition of *college* under Section 2(f)/12(B), UGC Act, 1956  
Affiliated to *Pandit Deendayal Upadhyaya Shekhawati University*, Sikar



Zoology Lab - Incubator

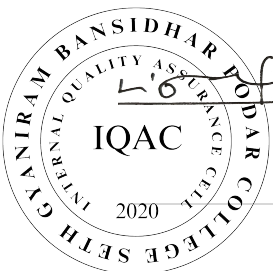



# SETH GYANIRAM BANSIDHAR PODAR COLLEGE

Accredited with 'A' Grade (3.04 CGPA) by NAAC-UGC  
Recognition of college under Section 2(f)/12(B), UGC Act, 1956  
Affiliated to Pandit Deendayal Upadhyaya Shekhawati University, Sikar



Specimen in Zoological Museum

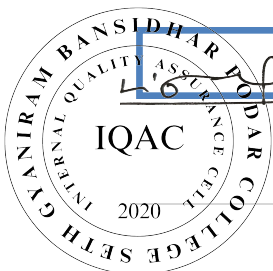





# SETH GYANIRAM BANSIDHAR PODAR COLLEGE

Accredited with 'A' Grade (3.04 CGPA) by NAAC-UGC  
Recognition of *college* under Section 2(f)/12(B), UGC Act, 1956  
Affiliated to *Pandit Deendayal* Upadhyaya *Shekhawati University*, Sikar

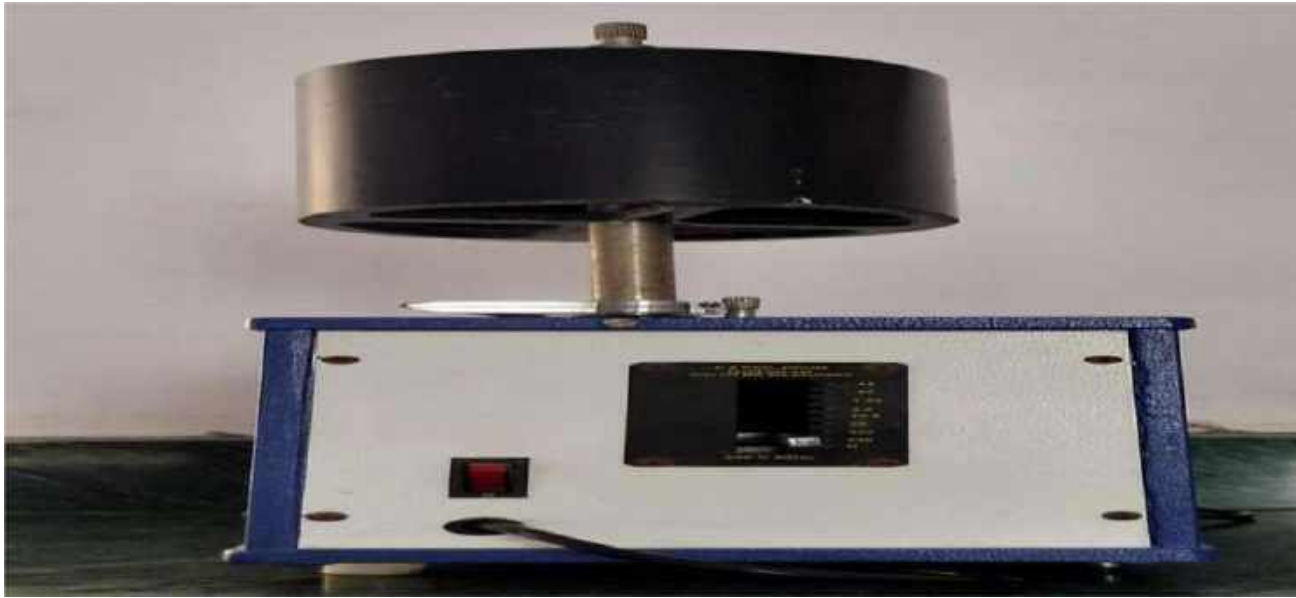

Zoology Lab - Rectangular Drum

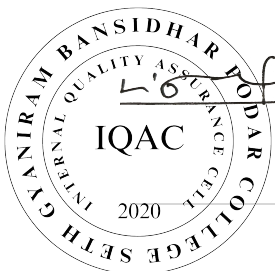



# SETH GYANIRAM BANSIDHAR PODAR COLLEGE

Accredited with 'A' Grade (3.04 CGPA) by NAAC-UGC  
Recognition of *college* under Section 2(f)/12(B), UGC Act, 1956  
Affiliated to *Pandit Deendayal Upadhyaya Shekhawati University*, Sikar

## Department of Botany



Botany- Corridor

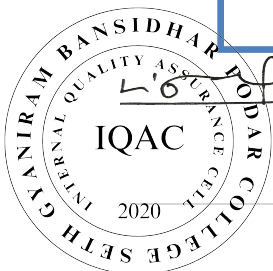



# SETH GYANIRAM BANSIDHAR PODAR COLLEGE

Accredited with 'A' Grade (3.04 CGPA) by NAAC-UGC  
Recognition of *college* under Section 2(f)/12(B), UGC Act, 1956  
Affiliated to *Pandit Deendayal* Upadhyaya *Shekhawati University*, Sikar



## Botany – PG Lab







# SETH GYANIRAM BANSIDHAR PODAR COLLEGE

Accredited with 'A' Grade (3.04 CGPA) by NAAC-UGC  
Recognition of *college* under Section 2(f)/12(B), UGC Act, 1956  
Affiliated to *Pandit Deendayal Upadhyaya Shekhawati University*, Sikar



**Botany- Culture Room**

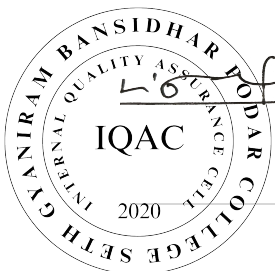



# SETH GYANIRAM BANSIDHAR PODAR COLLEGE

Accredited with 'A' Grade (3.04 CGPA) by NAAC-UGC  
Recognition of college under Section 2(f)/12(B), UGC Act, 1956  
Affiliated to Pandit Deendayal Upadhyaya Shekhawati University, Sikar



|            |               |
|------------|---------------|
| Department | Botany Lab    |
| ICT Tool   | LCD Projector |



*[Handwritten signature]*



# SETH GYANIRAM BANSIDHAR PODAR COLLEGE

Accredited with 'A' Grade (3.04 CGPA) by NAAC-UGC  
Recognition of college under Section 2(f)/12(B), UGC Act, 1956  
Affiliated to Pandit Deendayal Upadhyaya Shekhawati University, Sikar



Botany Lab - Centrifuge







# SETH GYANIRAM BANSIDHAR PODAR COLLEGE

Accredited with 'A' Grade (3.04 CGPA) by NAAC-UGC  
Recognition of *college* under Section 2(f)/12(B), UGC Act, 1956  
Affiliated to *Pandit Deendayal Upadhyaya Shekhawati University*, Sikar



**Botany Lab - Model**

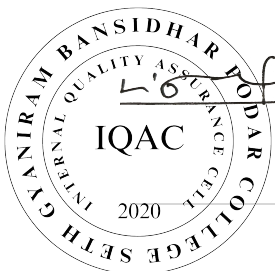

*[Handwritten signature]*





# SETH GYANIRAM BANSIDHAR PODAR COLLEGE

Accredited with 'A' Grade (3.04 CGPA) by NAAC-UGC  
Recognition of college under Section 2(f)/12(B), UGC Act, 1956  
Affiliated to Pandit Deendayal Upadhyaya Shekhawati University, Sikar



Botany Lab - Laminar

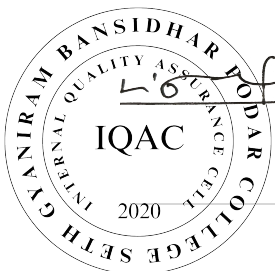



# SETH GYANIRAM BANSIDHAR PODAR COLLEGE

Accredited with 'A' Grade (3.04 CGPA) by NAAC-UGC  
Recognition of college under Section 2(f)/12(B), UGC Act, 1956  
Affiliated to Pandit Deendayal Upadhyaya Shekhawati University, Sikar



**Botany Lab - Hot Air Oven**





# SETH GYANIRAM BANSIDHAR PODAR COLLEGE

Accredited with 'A' Grade (3.04 CGPA) by NAAC-UGC  
Recognition of college under Section 2(f)/12(B), UGC Act, 1956  
Affiliated to Pandit Deendayal Upadhyaya Shekhawati University, Sikar



Botany Lab - Spectrophotometer

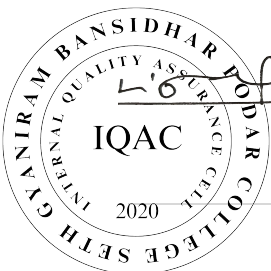



# SETH GYANIRAM BANSIDHAR PODAR COLLEGE

Accredited with 'A' Grade (3.04 CGPA) by NAAC-UGC  
Recognition of *college* under Section 2(f)/12(B), UGC Act, 1956  
Affiliated to *Pandit Deendayal* Upadhyaya *Shekhawati University*, Sikar



Botany Lab - High Volume Sampler







# SETH GYANIRAM BANSIDHAR PODAR COLLEGE

Accredited with 'A' Grade (3.04 CGPA) by NAAC-UGC  
Recognition of *college* under Section 2(f)/12(B), UGC Act, 1956  
Affiliated to *Pandit Deendayal* Upadhyaya *Shekhawati University*, Sikar

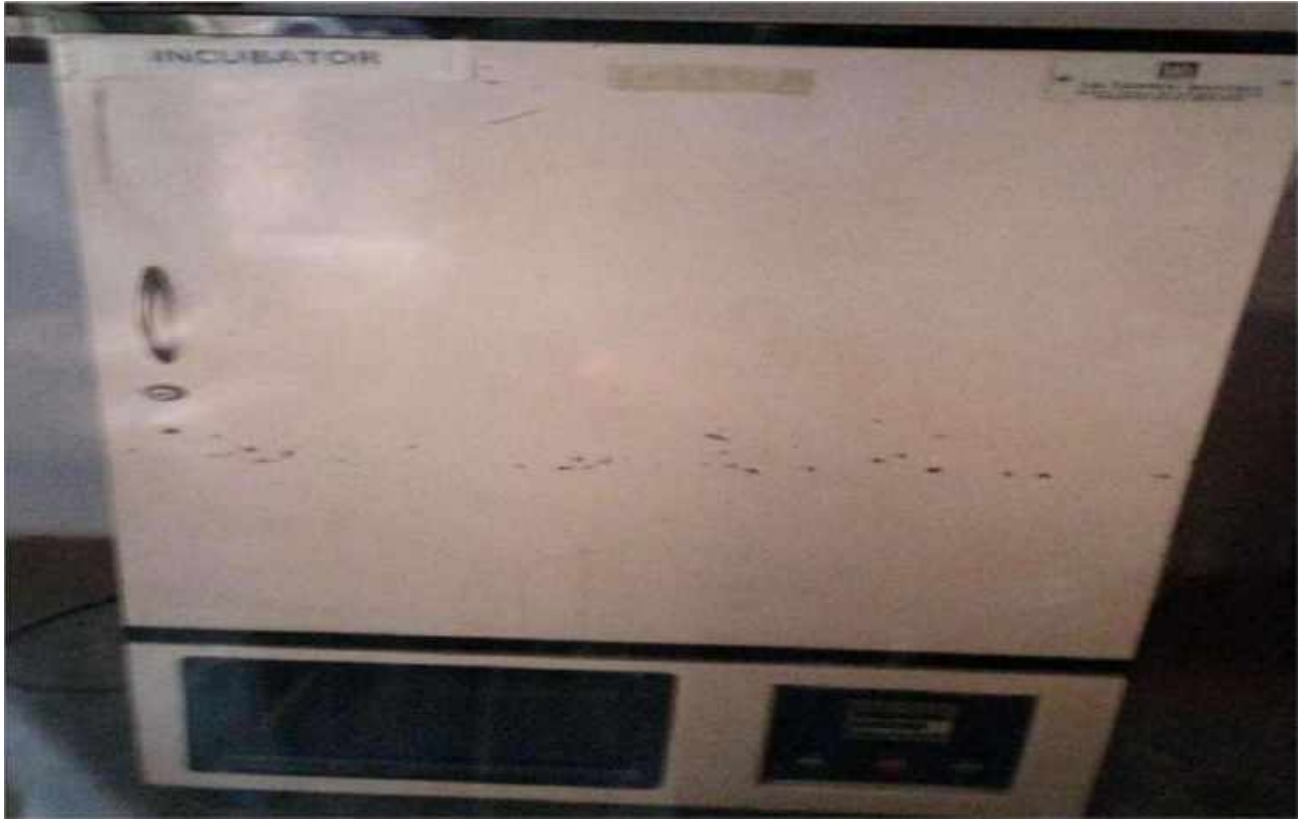

Botany Lab - Incubator

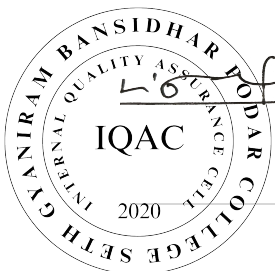

*[Handwritten signature]*



# SETH GYANIRAM BANSIDHAR PODAR COLLEGE

Accredited with 'A' Grade (3.04 CGPA) by NAAC-UGC  
Recognition of *college* under Section 2(f)/12(B), UGC Act, 1956  
Affiliated to *Pandit Deendayal* Upadhyaya *Shekhawati University*, Sikar

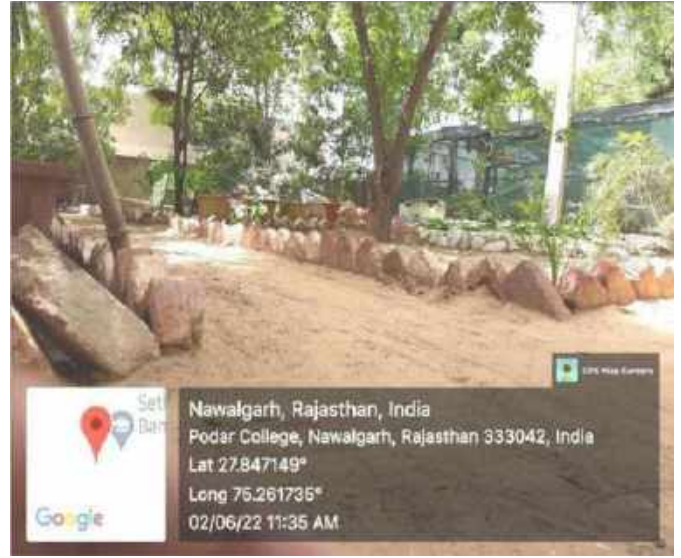

## Botanical Garden



*[Handwritten signature]*





# SETH GYANIRAM BANSIDHAR PODAR COLLEGE

Accredited with 'A' Grade (3.04 CGPA) by NAAC-UGC  
Recognition of college under Section 2(f)/12(B), UGC Act, 1956  
Affiliated to Pandit Deendayal Upadhyaya Shekhawati University, Sikar

## Department of Physics



Physics- Lab





# SETH GYANIRAM BANSIDHAR PODAR COLLEGE

Accredited with 'A' Grade (3.04 CGPA) by NAAC-UGC  
Recognition of *college* under Section 2(f)/12(B), UGC Act, 1956  
Affiliated to *Pandit Deendayal Upadhyaya Shekhawati University*, Sikar



## Physics Lab-2







# SETH GYANIRAM BANSIDHAR PODAR COLLEGE

Accredited with 'A' Grade (3.04 CGPA) by NAAC-UGC  
Recognition of *college* under Section 2(f)/12(B), UGC Act, 1956  
Affiliated to *Pandit Deendayal* Upadhyaya *Shekhawati University*, Sikar



## Physics Lab-3





# SETH GYANIRAM BANSIDHAR PODAR COLLEGE

Accredited with 'A' Grade (3.04 CGPA) by NAAC-UGC  
Recognition of college under Section 2(f)/12(B), UGC Act, 1956  
Affiliated to Pandit Deendayal Upadhyaya Shekhawati University, Sikar



## ZEEMAN EFFECT





# SETH GYANIRAM BANSIDHAR PODAR COLLEGE

Accredited with 'A' Grade (3.04 CGPA) by NAAC-UGC  
Recognition of *college* under Section 2(f)/12(B), UGC Act, 1956  
Affiliated to *Pandit Deendayal Upadhyaya Shekhawati University*, Sikar



Physics Lab

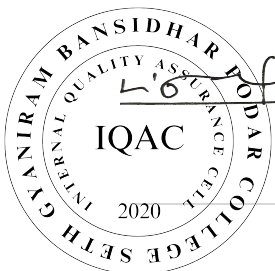





# SETH GYANIRAM BANSIDHAR PODAR COLLEGE

Accredited with 'A' Grade (3.04 CGPA) by NAAC-UGC  
Recognition of college under Section 2(f)/12(B), UGC Act, 1956  
Affiliated to Pandit Deendayal Upadhyaya Shekhawati University, Sikar



Physics Lab - E.M.F. THERMONIC EMISSION



Physics Lab - NVIS-214

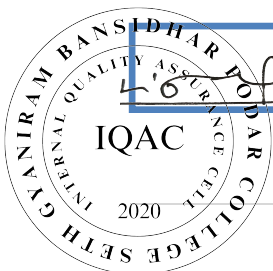





# SETH GYANIRAM BANSIDHAR PODAR COLLEGE

Accredited with 'A' Grade (3.04 CGPA) by NAAC-UGC  
Recognition of college under Section 2(f)/12(B), UGC Act, 1956  
Affiliated to Pandit Deendayal Upadhyaya Shekhawati University, Sikar



Physics Lab - HALL EFFECT



Physics- Lab





# SETH GYANIRAM BANSIDHAR PODAR COLLEGE

Accredited with 'A' Grade (3.04 CGPA) by NAAC-UGC  
Recognition of *college* under Section 2(f)/12(B), UGC Act, 1956  
Affiliated to *Pandit Deendayal* Upadhyaya *Shekhawati University*, Sikar



Physics- Dark Room

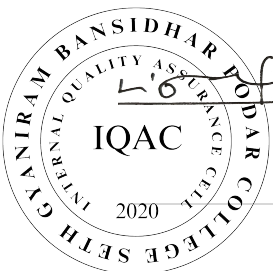



# SETH GYANIRAM BANSIDHAR PODAR COLLEGE

Accredited with 'A' Grade (3.04 CGPA) by NAAC-UGC  
Recognition of *college* under Section 2(f)/12(B), UGC Act, 1956  
Affiliated to *Pandit Deendayal Upadhyaya Shekhawati University*, Sikar



Physics- Lab

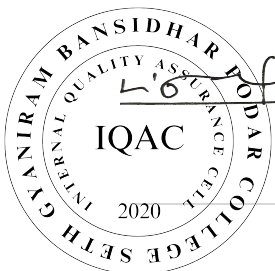





# SETH GYANIRAM BANSIDHAR PODAR COLLEGE

Accredited with 'A' Grade (3.04 CGPA) by NAAC-UGC  
Recognition of *college* under Section 2(f)/12(B), UGC Act, 1956  
Affiliated to *Pandit Deendayal* Upadhyaya *Shekhawati University*, Sikar

## Department of Geography



### Geography Department





# SETH GYANIRAM BANSIDHAR PODAR COLLEGE

Accredited with 'A' Grade (3.04 CGPA) by NAAC-UGC  
Recognition of *college* under Section 2(f)/12(B), UGC Act, 1956  
Affiliated to *Pandit Deendayal Upadhyaya Shekhawati University*, Sikar



Geography Lab

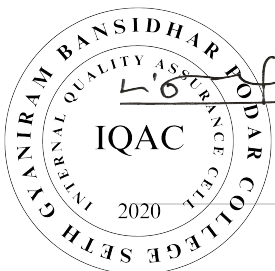

*[Handwritten signature]*



# SETH GYANIRAM BANSIDHAR PODAR COLLEGE

Accredited with 'A' Grade (3.04 CGPA) by NAAC-UGC  
Recognition of *college* under Section 2(f)/12(B), UGC Act, 1956  
Affiliated to *Pandit Deendayal* Upadhyaya *Shekhawati University*, Sikar



**Department of Computer Science & Management Studies**



*[Signature]*





# SETH GYANIRAM BANSIDHAR PODAR COLLEGE

Accredited with 'A' Grade (3.04 CGPA) by NAAC-UGC  
Recognition of college under Section 2(f)/12(B), UGC Act, 1956  
Affiliated to Pandit Deendayal Upadhyaya Shekhawati University, Sikar



Computer Science & Management Studies





# SETH GYANIRAM BANSIDHAR PODAR COLLEGE

Accredited with 'A' Grade (3.04 CGPA) by NAAC-UGC  
Recognition of college under Section 2(f)/12(B), UGC Act, 1956  
Affiliated to Pandit Deendayal Upadhyaya Shekhawati University, Sikar



|                      |  |
|----------------------|--|
| <b>Department</b>    | <b>Computer Science &amp; Management Studies</b> |
| <b>Computer Labs</b> |  |



*[Handwritten signature]*





# SETH GYANIRAM BANSIDHAR PODAR COLLEGE

Accredited with 'A' Grade (3.04 CGPA) by NAAC-UGC  
Recognition of college under Section 2(f)/12(B), UGC Act, 1956  
Affiliated to Pandit Deendayal Upadhyaya Shekhawati University, Sikar



 **GPS Map Camera**

Nawalgarh, Rajasthan, India

V749+JVX Koolwal Marriage Garden, Nawalgarh, Rajasthan 333042, India



 **GPS Map Camera**

Nawalgarh, Rajasthan, India

R7W6+VRC, Nawalgarh, Rajasthan 333042, India



 **GPS Map Camera**

Nawalgarh, Rajasthan, India

R7X6+4Q5, Poddar College Rd, Nawalgarh Rajasthan 333042, India

Lat 27.847589°

Long 75.26194°

31/01/23 12:59 PM GMT +05:30

|                        |  |
|------------------------|--|
| <b>Department</b>      | <b>Computer Science &amp; Management Studies</b> |
| <b>Smart Classroom</b> |  |



*[Handwritten signature]*





# SETH GYANIRAM BANSIDHAR PODAR COLLEGE

Accredited with 'A' Grade (3.04 CGPA) by NAAC-UGC  
Recognition of college under Section 2(f)/12(B), UGC Act, 1956  
Affiliated to Pandit Deendayal Upadhyaya Shekhawati University, Sikar



Department of Commerce

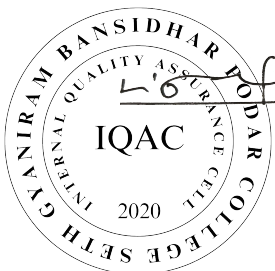



# SETH GYANIRAM BANSIDHAR PODAR COLLEGE

Accredited with 'A' Grade (3.04 CGPA) by NAAC-UGC  
Recognition of *college* under Section 2(f)/12(B), UGC Act, 1956  
Affiliated to *Pandit Deendayal* Upadhyaya *Shekhawati University*, Sikar

71

Department of  
Humanities



Department of Humanities



*[Handwritten signature]*



# SETH GYANIRAM BANSIDHAR PODAR COLLEGE

Accredited with 'A' Grade (3.04 CGPA) by NAAC-UGC  
Recognition of college under Section 2(f)/12(B), UGC Act, 1956  
Affiliated to Pandit Deendayal Upadhyaya Shekhawati University, Sikar



**Furniture in Classroom**

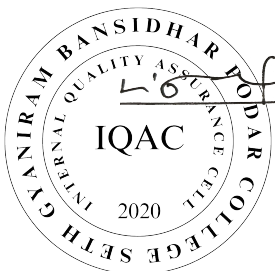





# SETH GYANIRAM BANSIDHAR PODAR COLLEGE

Accredited with 'A' Grade (3.04 CGPA) by NAAC-UGC  
Recognition of *college* under Section 2(f)/12(B), UGC Act, 1956  
Affiliated to *Pandit Deendayal* Upadhyaya *Shekhawati University*, Sikar



**N.R.S.C. Room**





# SETH GYANIRAM BANSIDHAR PODAR COLLEGE

Accredited with 'A' Grade (3.04 CGPA) by NAAC-UGC  
Recognition of college under Section 2(f)/12(B), UGC Act, 1956  
Affiliated to Pandit Deendayal Upadhyaya Shekhawati University, Sikar

## Sports



**Dr. Ramnath A. Podar Sports Complex**







# SETH GYANIRAM BANSIDHAR PODAR COLLEGE

Accredited with 'A' Grade (3.04 CGPA) by NAAC-UGC  
Recognition of *college* under Section 2(f)/12(B), UGC Act, 1956  
Affiliated to *Pandit Deendayal* Upadhyaya *Shekhawati University*, Sikar



Cricket Ground







# SETH GYANIRAM BANSIDHAR PODAR COLLEGE

Accredited with 'A' Grade (3.04 CGPA) by NAAC-UGC  
Recognition of college under Section 2(f)/12(B), UGC Act, 1956  
Affiliated to Pandit Deendayal Upadhyaya Shekhawati University, Sikar



Sports Ground- Kabbadi



*[Handwritten signature]*



# SETH GYANIRAM BANSIDHAR PODAR COLLEGE

Accredited with 'A' Grade (3.04 CGPA) by NAAC-UGC  
Recognition of college under Section 2(f)/12(B), UGC Act, 1956  
Affiliated to Pandit Deendayal Upadhyaya Shekhawati University, Sikar



Football Ground







# SETH GYANIRAM BANSIDHAR PODAR COLLEGE

Accredited with 'A' Grade (3.04 CGPA) by NAAC-UGC  
Recognition of *college* under Section 2(f)/12(B), UGC Act, 1956  
Affiliated to *Pandit Deendayal* Upadhyaya *Shekhawati University*, Sikar



**Volleyball Ground**



*[Handwritten Signature]*





# SETH GYANIRAM BANSIDHAR PODAR COLLEGE

Accredited with 'A' Grade (3.04 CGPA) by NAAC-UGC  
Recognition of *college* under Section 2(f)/12(B), UGC Act, 1956  
Affiliated to *Pandit Deendayal* Upadhyaya *Shekhawati University*, Sikar



**Badminton Court**



**Gym**

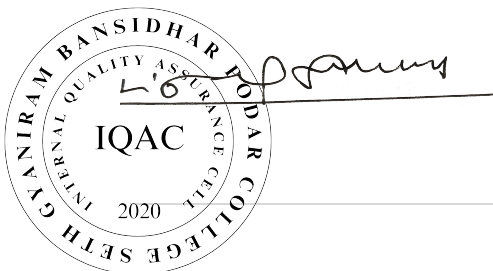



# SETH GYANIRAM BANSIDHAR PODAR COLLEGE

Accredited with 'A' Grade (3.04 CGPA) by NAAC-UGC  
Recognition of *college* under Section 2(f)/12(B), UGC Act, 1956  
Affiliated to *Pandit Deendayal Upadhyaya Shekhawati University*, Sikar



Medical Room





# SETH GYANIRAM BANSIDHAR PODAR COLLEGE

Accredited with 'A' Grade (3.04 CGPA) by NAAC-UGC  
Recognition of college under Section 2(f)/12(B), UGC Act, 1956  
Affiliated to Pandit Deendayal Upadhyaya Shekhawati University, Sikar



College Parking



*[Handwritten signature]*





# SETH GYANIRAM BANSIDHAR PODAR COLLEGE

Accredited with 'A' Grade (3.04 CGPA) by NAAC-UGC  
Recognition of college under Section 2(f)/12(B), UGC Act, 1956  
Affiliated to Pandit Deendayal Upadhyaya Shekhawati University, Sikar



**Electric Power Room**





# SETH GYANIRAM BANSIDHAR PODAR COLLEGE

Accredited with 'A' Grade (3.04 CGPA) by NAAC-UGC  
Recognition of college under Section 2(f)/12(B), UGC Act, 1956  
Affiliated to Pandit Deendayal Upadhyaya Shekhawati University, Sikar



NCC Office







# SETH GYANIRAM BANSIDHAR PODAR COLLEGE

Accredited with 'A' Grade (3.04 CGPA) by NAAC-UGC  
Recognition of college under Section 2(f)/12(B), UGC Act, 1956  
Affiliated to Pandit Deendayal Upadhyaya Shekhawati University, Sikar



A View of Yoga session



*[Handwritten signature]*





# SETH GYANIRAM BANSIDHAR PODAR COLLEGE

Accredited with 'A' Grade (3.04 CGPA) by NAAC-UGC  
Recognition of *college* under Section 2(f)/12(B), UGC Act, 1956  
Affiliated to *Pandit Deendayal* Upadhyaya *Shekhawati University*, Sikar



Swimming Pool





# SETH GYANIRAM BANSIDHAR PODAR COLLEGE

Accredited with 'A' Grade (3.04 CGPA) by NAAC-UGC  
Recognition of college under Section 2(f)/12(B), UGC Act, 1956  
Affiliated to Pandit Deendayal Upadhyaya Shekhawati University, Sikar



Scout & Guide Rover



*[Handwritten signature]*





# SETH GYANIRAM BANSIDHAR PODAR COLLEGE

Accredited with 'A' Grade (3.04 CGPA) by NAAC-UGC  
Recognition of college under Section 2(f)/12(B), UGC Act, 1956  
Affiliated to Pandit Deendayal Upadhyaya Shekhawati University, Sikar



|            |                 |
|------------|-----------------|
| Department | Conference Hall |
| ICT Tool   | LCD Projector   |

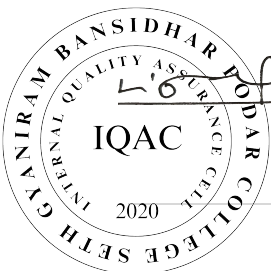





# SETH GYANIRAM BANSIDHAR PODAR COLLEGE

Accredited with 'A' Grade (3.04 CGPA) by NAAC-UGC  
Recognition of college under Section 2(f)/12(B), UGC Act, 1956  
Affiliated to Pandit Deendayal Upadhyaya Shekhawati University, Sikar

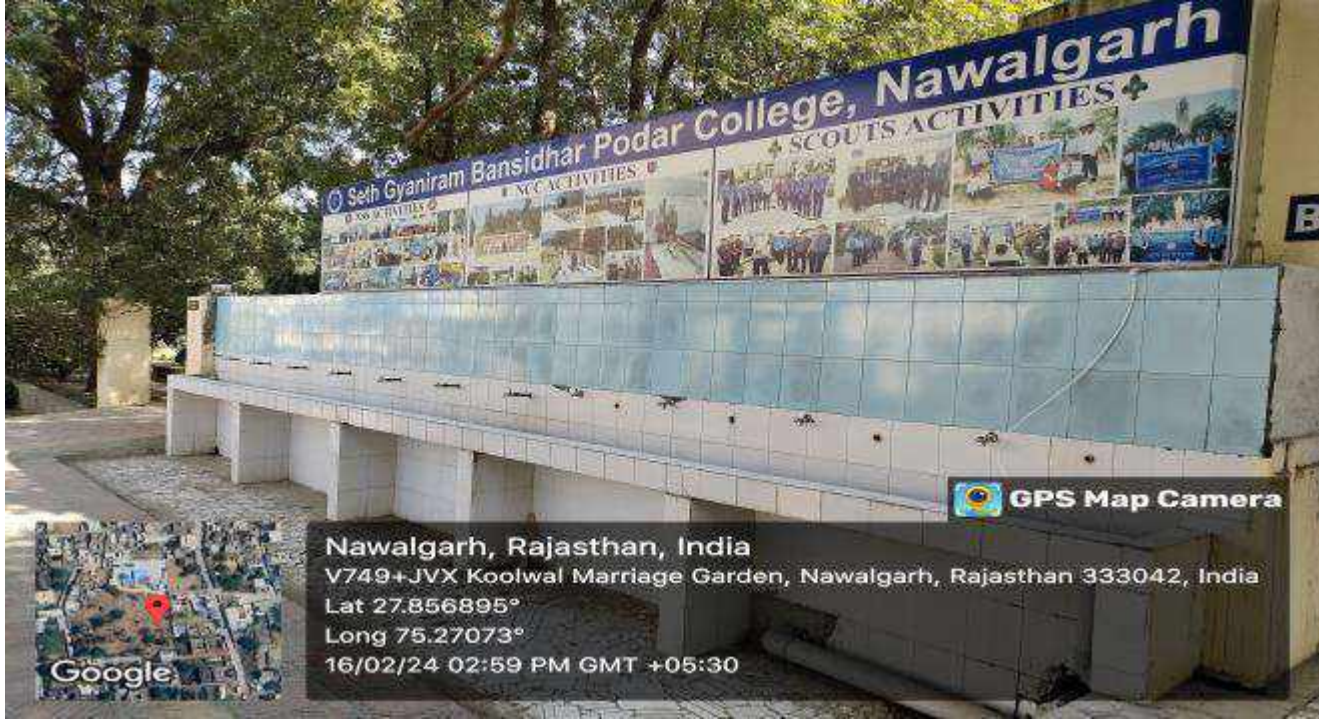

Drinking water



*[Handwritten signature]*



# SETH GYANIRAM BANSIDHAR PODAR COLLEGE

Accredited with 'A' Grade (3.04 CGPA) by NAAC-UGC  
Recognition of college under Section 2(f)/12(B), UGC Act, 1956  
Affiliated to Pandit Deendayal Upadhyaya Shekhawati University, Sikar



Female Facilities



Male Facilities



*[Handwritten signature]*





# SETH GYANIRAM BANSIDHAR PODAR COLLEGE

Accredited with 'A' Grade (3.04 CGPA) by NAAC-UGC  
Recognition of *college* under Section 2(f)/12(B), UGC Act, 1956  
Affiliated to *Pandit Deendayal* Upadhyaya *Shekhawati University*, Sikar



**Girls Hostel**



*[Handwritten Signature]*





# SETH GYANIRAM BANSIDHAR PODAR COLLEGE

Accredited with 'A' Grade (3.04 CGPA) by NAAC-UGC  
Recognition of *college* under Section 2(f)/12(B), UGC Act, 1956  
Affiliated to *Pandit Deendayal Upadhyaya Shekhawati University*, Sikar



College Mess

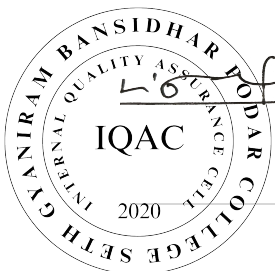

*[Handwritten Signature]*



# SETH GYANIRAM BANSIDHAR PODAR COLLEGE

Accredited with 'A' Grade (3.04 CGPA) by NAAC-UGC  
Recognition of *college* under Section 2(f)/12(B), UGC Act, 1956  
Affiliated to *Pandit Deendayal* Upadhyaya *Shekhawati University*, Sikar



**College Canteen**





# SETH GYANIRAM BANSIDHAR PODAR COLLEGE

Accredited with 'A' Grade (3.04 CGPA) by NAAC-UGC  
Recognition of college under Section 2(f)/12(B), UGC Act, 1956  
Affiliated to Pandit Deendayal Upadhyaya Shekhawati University, Sikar



NSS Office







# SETH GYANIRAM BANSIDHAR PODAR COLLEGE

Accredited with 'A' Grade (3.04 CGPA) by NAAC-UGC  
Recognition of college under Section 2(f)/12(B), UGC Act, 1956  
Affiliated to Pandit Deendayal Upadhyaya Shekhawati University, Sikar



NSS UNIT- I & II





# SETH GYANIRAM BANSIDHAR PODAR COLLEGE

Accredited with 'A' Grade (3.04 CGPA) by NAAC-UGC  
Recognition of *college* under Section 2(f)/12(B), UGC Act, 1956  
Affiliated to *Pandit Deendayal Upadhyaya Shekhawati University*, Sikar



## Poster Competition







# SETH GYANIRAM BANSIDHAR PODAR COLLEGE

Accredited with 'A' Grade (3.04 CGPA) by NAAC-UGC  
Recognition of college under Section 2(f)/12(B), UGC Act, 1956  
Affiliated to Pandit Deendayal Upadhyaya Shekhawati University, Sikar



Rangoli

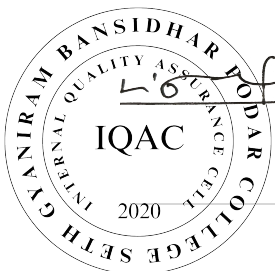





# SETH GYANIRAM BANSIDHAR PODAR COLLEGE

Accredited with 'A' Grade (3.04 CGPA) by NAAC-UGC  
Recognition of college under Section 2(f)/12(B), UGC Act, 1956  
Affiliated to Pandit Deendayal Upadhyaya Shekhawati University, Sikar



Annual Function



*[Handwritten signature]*



# SETH GYANIRAM BANSIDHAR PODAR COLLEGE

Accredited with 'A' Grade (3.04 CGPA) by NAAC-UGC  
Recognition of college under Section 2(f)/12(B), UGC Act, 1956  
Affiliated to Pandit Deendayal Upadhyaya Shekhawati University, Sikar



Fresher & Farewell Parties

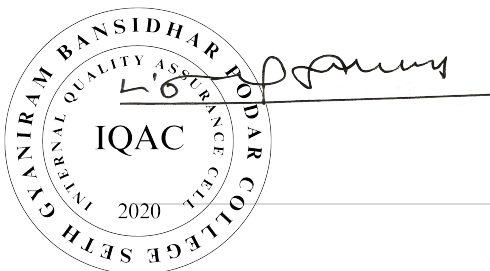





# SETH GYANIRAM BANSIDHAR PODAR COLLEGE

Accredited with 'A' Grade (3.04 CGPA) by NAAC-UGC  
Recognition of *college* under Section 2(f)/12(B), UGC Act, 1956  
Affiliated to *Pandit Deendayal Upadhyaya Shekhawati University*, Sikar



Student Welfare Cell

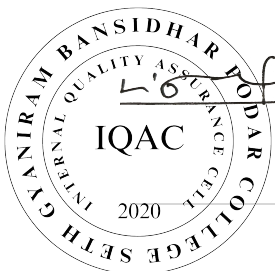

*[Handwritten Signature]*





# SETH GYANIRAM BANSIDHAR PODAR COLLEGE

Accredited with 'A' Grade (3.04 CGPA) by NAAC-UGC  
Recognition of college under Section 2(f)/12(B), UGC Act, 1956  
Affiliated to Pandit Deendayal Upadhyaya Shekhawati University, Sikar



Plastic free Campus

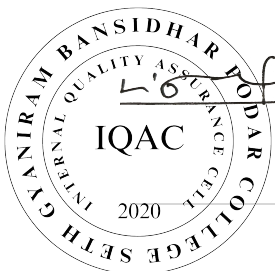



# SETH GYANIRAM BANSIDHAR PODAR COLLEGE

Accredited with 'A' Grade (3.04 CGPA) by NAAC-UGC  
Recognition of *college* under Section 2(f)/12(B), UGC Act, 1956  
Affiliated to *Pandit Deendayal* Upadhyaya *Shekhawati University*, Sikar



Alumni Cell



*[Handwritten signature]*



# SETH GYANIRAM BANSIDHAR PODAR COLLEGE

Accredited with 'A' Grade (3.04 CGPA) by NAAC-UGC  
Recognition of *college* under Section 2(f)/12(B), UGC Act, 1956  
Affiliated to *Pandit Deendayal* Upadhyaya *Shekhawati University*, Sikar



**Women Cell**







# SETH GYANIRAM BANSIDHAR PODAR COLLEGE

Accredited with 'A' Grade (3.04 CGPA) by NAAC-UGC  
Recognition of college under Section 2(f)/12(B), UGC Act, 1956  
Affiliated to Pandit Deendayal Upadhyaya Shekhawati University, Sikar



## Scholarship

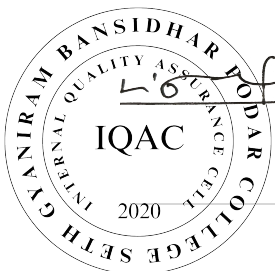

*[Handwritten Signature]*



# SETH GYANIRAM BANSIDHAR PODAR COLLEGE

Accredited with 'A' Grade (3.04 CGPA) by NAAC-UGC  
Recognition of *college* under Section 2(f)/12(B), UGC Act, 1956  
Affiliated to *Pandit Deendayal* Upadhyaya *Shekhawati University*, Sikar



Rest Room for Girls

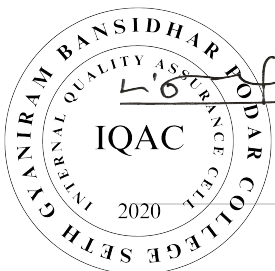

*[Handwritten signature]*



# SETH GYANIRAM BANSIDHAR PODAR COLLEGE

Accredited with 'A' Grade (3.04 CGPA) by NAAC-UGC  
Recognition of *college* under Section 2(f)/12(B), UGC Act, 1956  
Affiliated to *Pandit Deendayal* Upadhyaya *Shekhawati University*, Sikar



**Girls Common Room**

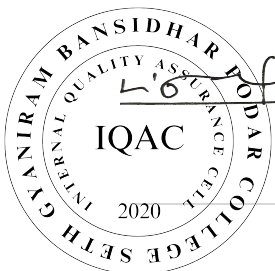

*[Handwritten signature]*





# SETH GYANIRAM BANSIDHAR PODAR COLLEGE

Accredited with 'A' Grade (3.04 CGPA) by NAAC-UGC  
Recognition of college under Section 2(f)/12(B), UGC Act, 1956  
Affiliated to Pandit Deendayal Upadhyaya Shekhawati University, Sikar



Counseling Room

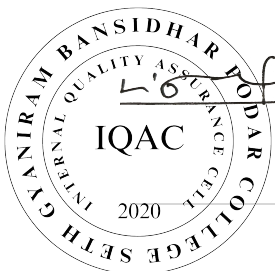



# SETH GYANIRAM BANSIDHAR PODAR COLLEGE

Accredited with 'A' Grade (3.04 CGPA) by NAAC-UGC  
Recognition of college under Section 2(f)/12(B), UGC Act, 1956  
Affiliated to Pandit Deendayal Upadhyaya Shekhawati University, Sikar



Grievance Redressal & Anti Ragging



*[Handwritten signature]*



# SETH GYANIRAM BANSIDHAR PODAR COLLEGE

Accredited with 'A' Grade (3.04 CGPA) by NAAC-UGC  
Recognition of *college* under Section 2(f)/12(B), UGC Act, 1956  
Affiliated to *Pandit Deendayal* Upadhyaya *Shekhawati University*, Sikar



**Ragging free Campus**

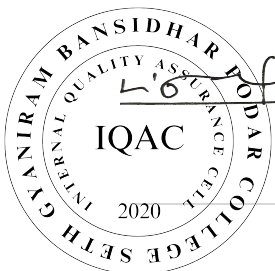

*[Handwritten signature]*